



# Team Leaders Manual

IndianOil New Delhi 2025 World Para Athletics Championships

## Welcome Message

### Paul FITZGERALD

Head of World Para Athletics



I am delighted to welcome you to New Delhi for the twelfth edition of the World Para Athletics Championships. The World Championships are the largest single Paralympic sporting event in the world. Each edition represents a new and important step in the growth and development of the sport as well a chance to showcase to the world what is possible for those 1.3 billion people who are living with a disability.

We are living a transformative time for Para sports – especially Para athletics – as we reach global audiences like never before. As we begin the journey towards the next Paralympic Games in Los Angeles, three years from now, India will witness the rise of new stars and the continued brilliance of Para athletics icons. This represents a unique opportunity for World Para Athletics and India to present our stars to the world and make an important impact in society's perception of persons with disabilities.

You are part of a historic moment: the largest Para sport event ever held in India. For nine days, the iconic Jawaharlal Nehru Stadium will showcase the world's best athletes, offering unforgettable stories and performances to share with the world. Spectators inside the stadium as well as a global audience around the world will experience the brilliance of Para athletics athletes competing on newly renovated facilities designed to maximise the preparation, hard work and talent of your athletes.

Along with the Organising Committee, we have worked hard to put on a special Championships because we know your athletes have worked their hardest to be ready for one of the most important events in their sporting careers. This Team Leader Manual contains everything you need to navigate the World Championships. If you need any assistance, please don't hesitate to contact the Local Organising Committee or the World Para Athletics Team.

Thank you for the work you do on a daily basis around the world. We look forward to working with you over the next weeks to ensure some amazing performances.

## Welcome Message



### Vanathi Srinivasan

Chairperson of the Local Organising Committee of the New Delhi 2025 Para Athletics World Championships

---

On behalf of the Paralympic Committee of India, it gives me immense joy to welcome you to New Delhi 2025 World Para Athletics Championships. This is a historic moment for India. We are proud to host this prestigious event for the very first time, and it is our privilege to have you here.

This Team Manual has been designed to guide you through your stay, your participation, and your overall experience in our city. Inside, you'll find everything you need to know— from competition details and services to everyday essentials—to help make your journey as smooth and memorable as possible.

New Delhi is a city of stories—where ancient monuments and modern life come together in harmony. Our people take pride in extending warmth and hospitality, and we hope to make you feel at home.

As organizers, our commitment is simple: we are here for you. Every member of our team is dedicated to ensuring your needs are met, on and off the field, so that you can focus on what you do best— giving your all in competition.

We believe these Championships will not only showcase world-class performances but also inspire countless hearts across India and beyond.

Welcome once again, and let us make history together.

## Welcome Message



### Devendra Jhajharia

President of the Paralympic Committee of India

---

As President of the Paralympic Committee of India, and as someone who has proudly lived the life of an athlete, it fills me with immense joy to welcome you to New Delhi 2025 World Para Athletics Championships.

This Championship marks a defining moment for our nation. For the first time, India has the privilege of hosting the world's finest para-athletes, and in doing so, we take a giant step forward in the journey of the Paralympic movement in our country. It is not just an event—it is a statement of our commitment to inclusion, equality, and excellence.

My vision, and that of the Paralympic Committee of India, is clear: para-athletes must be celebrated with the same dignity, respect, and recognition as any other athlete. Your determination, discipline, and achievements are no less extraordinary. This Championship is an opportunity to show the world—and our own people—that sport has the power to break barriers, change perceptions, and inspire future generations.

Together, let us make this Championship a turning point—one that uplifts para sport and leaves a lasting legacy for athletes everywhere. Please know that here in India, you will find not just competition, but also friendship, warmth, and an unwavering support system.

With great pride and heartfelt wishes for your success

# Table of Contents

<b>1. General Information .....</b>	
1.1 World Para Athletics (WPA) and International Paralympic Committee (IPC).....	
1.2 Local Organizing Committee (LOC) .....	
1.3 International Officials.....	
1.4 General Programme (Provisional).....	
1.5 Information about Host Country and Host City.....	
<b>2. Travel to New Delhi .....</b>	
2.1 Entry Visa.....	
2.2 Insurance .....	
2.3 Arrivals and Departures .....	
2.4 Competition Equipment/Implements Transport (Racing Chairs, Race Running, and Throwing Frames)	
2.4.1 Arrival.....	
2.4.2 Training/Competition Period .....	
2.4.3 Departure .....	
<b>3. Accreditation .....</b>	
3.1 Accreditation Centre Check-in .....	
3.2 Accreditation Access.....	
3.2.1 Loss of Accreditation Badge .....	
3.2.2 Special Passes .....	
3.2.3 Personal Coach and Training Partner.....	
3.3 Athlete Uniform Inspection .....	
3.3.1 Championships Inspection Procedures.....	
<b>4. Accommodation .....</b>	
4.1 NPC Hotels .....	
4.2 Meals .....	
<b>5. Transport.....</b>	
5.1 Transport Information.....	
5.1.1 Airport Transfer .....	
5.1.2 Transport between Official Team Hotels and Competition &	

Training Venues.....	
5.2 Transport Rights on Accreditation.....	
5.3 Public Transport.....	
<b>6. Information Centre .....</b>	
6.1 Technical Information Centre – TIC (Competition Venue) .....	
6.1.1 Functions of the TIC.....	
6.2 Environment Responsibility and Information Updates .....	
6.3 Information Desks .....	
<b>7. Technical Meeting .....</b>	
7.1 Technical Meeting Information .....	
7.1.1 Submission of Questions .....	
7.2 Team Leaders Orientation Visit.....	
<b>8. Entries and Final Confirmation .....</b>	
8.1 Entry Regulations.....	
8.1.1 Declaration of Participation .....	
8.1.2 Athlete Programme .....	
8.2 Final Entries .....	
8.3 Event Viability Criteria .....	
8.3.1 Before Final Entry Deadline .....	
8.3.2 After Final Entry Deadline .....	
8.4 Qualification Rounds.....	
8.4.1 Seated Throw Events.....	
8.4.2 Ambulant Throw and Long Jump Events .....	
8.4.3 Track Events .....	
8.4.4 Qualification Round Timetable.....	
8.5 Final Confirmations .....	
8.5.1 General .....	
8.5.2 Withdrawals .....	
<b>9. Training, Warm-Up, and Competition Venues .....</b>	
9.1 Training Venues.....	
9.1.1 Commonwealth Games Village.....	
9.1.2 Thyagraj Stadium.....	
9.2 Warm Up Area .....	
9.2.1 Warm-Up Times at Jawahar Lal Nehru Stadium.....	
9.2.2 Starter's Practice in Competition Venue .....	

9.2.3 Team Tents .....	
9.2.4 Repair Services .....	
9.3 Competition Venue: Jawaharlal Nehru Stadium, New Delhi .....	
9.3.1 Stadium Presentation .....	
9.3.2 Competition Stadium - Mondo Track Specifications .....	
9.3.3 Stadium Layout .....	
<b>10. Competition Procedures, Equipment and Implements .....</b>	
10.1 Confirmation of Starting Heights, Distances, and Progressions ..	
10.2 Sports Equipment .....	
10.2.1 Markers .....	
10.2.2 Official Implements .....	
10.2.3 Personal Implements .....	
10.2.4 Equipment Checks .....	
10.3 Competition Schedule .....	
10.4 Athletes' Bibs .....	
10.4.1 Bibs .....	
10.4.2 Relays .....	
10.4.3 Hip Numbers .....	
10.5 Athlete Uniform Inspection During Competition .....	
10.6 Call Room .....	
10.6.1 Personal Belongings .....	
10.6.2 Throwing Frame Check In .....	
10.6.3 Call Room Reporting Times .....	
10.6.4 Call Room Procedures .....	
10.7 Entry onto Field of Play .....	
10.8 Specific Event Procedures .....	
10.8.1 Track Events .....	
10.8.2 Vacant Positions Due to Withdrawals in Track Semi Finals and Finals .....	
10.8.3 Field Events Trials .....	
10.8.4 Guide-runner Substitution .....	
10.8.5 Sport Class Changes and Re-entry Regulations .....	
10.8.6 Relays .....	
10.8.7 Failure to Participate .....	
10.8.8 Coaching Zone .....	
10.9 Timing and Measurements .....	
10.10 Post Competition Procedures .....	
10.10.1 Anti-Doping Control .....	

10.11	Technical Protests and Appeals.....	
10.11.1	Protests.....	
10.11.2	Appeals .....	
10.12	Victory Ceremonies.....	
<b>11.</b>	<b>Classification .....</b>	
11.1	NPC Responsibilities.....	
11.2	Sport Class Status .....	
11.3	Pre-Championships Classifications Activities .....	
11.3.1	Classification Master List .....	
11.3.2	Classification Evaluation Schedule .....	
11.4	In-Competition Classification Activities .....	
11.4.1	Classification Evaluation Period.....	
11.4.2	Classification Competition Period-Observation in Competition .....	
11.4.3	Sport Class Changes .....	
11.4.4	Change of Class during Competition .....	
11.5	Classification Protests.....	
11.5.1	National Protest Deadlines .....	
11.5.2	World Para Athletics Protest .....	
11.6	Classification Appeals .....	
<b>12.</b>	<b>Medical Services .....</b>	
12.1	Competition Venue.....	
12.2	Training Venues .....	
12.3	Warm-Up Area .....	
12.4	Dedicated Hospitals .....	
12.5	Team Hotels.....	
12.6	Emergency Contact Numbers .....	
12.7	Medical Delegate and Procedures During Competition .....	
12.8	Medical Briefing.....	
12.9	Medical Insurance .....	
12.10	Narcotics and Psychotropics.....	
12.11	Distribution of Ice .....	
12.12	Medication or Medical Equipment Import.....	
12.13	Autonomic Dysreflexia and Boosting .....	
12.14	Infectious Disease Countermeasures .....	



<b>13. Doping Control</b>	.....
13.1 Doping Control Procedures	.....
13.2 Athletes that Already Have a Valid TUE Certificate of Approval	.....
13.3 Athletes that Need to Apply for a New TUE	.....
13.4 Retroactive TUE	.....
<b>14. Cultural Experiences and Stalls</b>	.....
14.1 Ministry of Textiles – Handloom and Handicraft Stalls	.....
14.2 TRIFED – Araku Valley Café cum Stall	.....
14.3 Para Sports Experience Zone – Ottobock and MSJE	.....
14.4 Souvenir Shop	.....
14.5 Mehndi Stall	.....
<b>15. Appendices</b>	.....
15.1 Appendix 1 (Competition Schedule)	.....
15.2 Appendix 2 (Athlete Flow)	.....
15.3 Appendix 3 (WPA Equipment and Implements List)	.....
15.4 Appendix 4 (Medal Ceremonies Schedule)	.....

# 1. General Information

## 1.1 World Para Athletics (WPA) and International Paralympic Committee (IPC)

### World Para Athletics Management Team (Staff)

Head of World Athletics	Paul FITZGERALD
Competitions Senior Manager	Martin CHORLEY
Competition Co-ordinator	Irina KHAPUGINA
Classification Co-ordinator	Henrietta KULLEBORN
Classification Co-ordinator	Eve OLIVARES

### International Paralympic Committee

Media Delegate	Rafael MARANHAO
Broadcasting Delegate	Josh LEE

## 1.2 Local Organising Committee (LOC)

### LOC Operational Staff

Chairperson	Smt. Vanathi Srinivasan
Organising Secretary	Mr. Jayawant G. H.
Joint Organising Secretary	Mr. Kirubakara Raja
Joint Organising Secretary	Mr. K R Satyababu
Chief LOC Coordinator	Mr. Rahul Swami
Competition Director	Mr. Satyapal Singh
Assistant Competition Director	Mr Diwakara T
Assistant Competition Director	Mr Rakesh Save
Accommodation Head	Mr. Satyanarayana
Deputy Medical Director	Brig. (Dr) Bibhu K. Nayak
Transportation Head	Mr. Jaspreet Singh
Broadcasting Head	Mr. Mahavir Rawat
Media Head	Mr. Akhilesh
Branding and Marketing Head	Mr. Shubham Arya
LOC coordinator	Mr. Vivek Saini
LOC Classification/Anti-Doping	Dr. Manish Rana

## 1.3 International Officials

### International Technical Officials (ITOs)

Technical Delegate (Lead)	Ruth LIONG (NZL)
Technical Delegate	Claudia SCHNECK (BRA) Didier FOULON (BEL)
Chair of Jury	Patrick VAN CAELENBERGHE (BEL)
Jury	Elena BARRIOS (ESP) Suren AYADASSEN (MRI)
Medical Delegate	Sivakumar GULASINGAM (CAN)

Anti-doping Delegate	David HERBERT(GBR)
Chief ITO	Ben VROOM (NED)
Video Referees	Trevor SPITTLE (NZL) Caroline JACKMAN (AUS)
Call Room Referee	Sue MAUGHAN (GBR) - Lead Kim OWENS (AUS)
Track Referee	Marnix DE MANGELAERE (BEL)
International Starter	Margaret WERRETT (GBR)
Start Referee	Su ZHANG (CHN)
International Photo Finish Judge	Annie CHEUNG (HKG)
International Technical Officials	Ernesta STRYDOM (RSA) Jerry CLAYTON (USA) Carlos BARRIOS (GUA) Sodia PETERS (JAM) Paul NICHOLLS (NZL) Alicia FRIDAY (CAN) Dachuan LIU (CHN) Eero KULMALA (FIN) Iva MACHOVA (CZE) Ludmila PUDILOVA (CZE)
WPA Competition Director	Giovanni CARDONA (COL)
WPA TIC Team	Corentin CORNETTE (FRA)
WPA Sport Equipment Support team	Juan Josué Acosta MORALES (MEX) Josué Lizarraga MORALES (MEX)
International Classifiers	
Chief Classifier	Rebecca FOULSHAM (NZL)
Physical Impairment (PI) Classifiers	Deanne FAY (USA) Aleksey MELNIKOV (RUS) Rory DIXON (JAM) Mohammed Amine KHELLADI (ALG) Elly SCHOUTEN (NED) Natalia SLADKOVA (RUS)
Vision Impairment (VI) Classifiers	Morteza NAJAFI (IRI) - VI Lead Classifier Chi-Ming CHAN (TPE) Tania JAIN (IND) Precious CHISALE (MAW)
Intellectual Impairment (II) Classifiers	Mohammad Hadi HADIZADEH (IRI) - II Lead Classifier Varsha SANNUTHI (IND)

## 1.4 General Programme (provisional)

Date	Time	Event	Location
22 September	All Day	Team arrivals	IGI Airport
23-25 September	As per Schedule	Accreditation Centre check-in	To be confirmed
23-25 September	As per Schedule	Classification	Classification room, near p1 (TIC), JLN stadium
24-25 September	As per Schedule	Visually Impaired(VI) Classification	Venu Eye Institute and Research Centre
23 September	9.00 Hrs	Start of training	Training venues
25 September	Start 09:00 see Section 9.2.2	Starters Practice	Competition stadium
26 September	10.00 Hrs	Technical meeting	Zora Convention Centre
26 September	11.00 Hrs	Team leaders Orientation	JLN stadium
26 September	12.00 Hrs	Medical Briefing	To be confirmed

## 1.5 Information about Host Country and City

Location	New Delhi, India: 28°36'50" N, 77°12'32" E
Population	India: 1.46 Billion New Delhi: 22.28 million
Climate	Hot Semi - Arid Climate (largely)
Capital	New Delhi
Language	Hindi & English
Religion	No state religion
Local Time	IST (Indian Standard Time), UTC +5.30 (IST)
Electricity	230 Volts
Driving	Left-hand Side Drive International Driving Permit required  Foreign Driver's Licenses and International Driving Permits ( <a href="https://sarathi.parivahan.gov.in/sarathiservice/stateSelection.do">https://sarathi.parivahan.gov.in/sarathiservice/stateSelection.do</a> )
International Calls	+91-11
Currency	Rupee (₹)

## 2. Travel to New Delhi

### 2.1 Entry VISA

---

India has strict regulations about who needs a VISA to enter the country. If you are a citizen of a country that requires an Indian VISA, you will **NOT** be allowed to enter the country without one.

You can find more information about e-VISA applications in India on this website: <https://indianvisaonline.gov.in/evisa/tvoa.html>

In case of any VISA-related query, the teams should contact the following as soon as possible: [wpa25-accommodation@paralympicindia.com](mailto:wpa25-accommodation@paralympicindia.com)

**NOTE: Countries that are not eligible to avail an e-VISA, should visit the Indian embassy in their respective countries to get a stamped VISA.**

The LOC and VISA Team bear no responsibility for delays or refusals in VISA applications. It is the sole responsibility of the NPC/NF to apply for the required VISAS well in advance, and all inquiries should be directed to the relevant embassy.

VISA support documents issued by the LOC do not guarantee admission to India. The final decision will be made by the Government of India.

### 2.2 Insurance

---

All delegation members—including athletes, guide-runners, and team officials—must obtain personal health, accident, and liability insurance.

The LOC assumes no responsibility for any accident, injury, illness, theft, or damage occurring at any point from arrival until departure from the Championships.

### 2.3 Arrivals and Departures

---

The official airport for the New Delhi 2025 World Para Athletics Championships is **Indira Gandhi International Airport (Airport Code - DEL)**. The LOC will provide transportation between the Official Airport and the Official Team Hotels, from **22 September to 6 October**, exclusively for NPCs accommodated at the Official Team Hotels.

If NPCs wish to travel from an airport other than the official airport, the transportation team can arrange transportation for NPCs **(additional charges will apply)**.

**Note:** For the LOC to arrange your airport transfers, it is imperative that NPCs provide correct arrival and departure information into the form sent by the LOC Accommodation Team so that the transportation team can arrange transfers accordingly. Any teams/athletes that do not provide their flight information will have no transport from the official airports to the Official Team Hotels.

## **2.4 Competition Equipment/Implements Transport (Racing Chairs, Running Frames and Throwing Frames)**

---

### **2.4.1 Arrival**

The LOC Transportation Team will pick up the Competition Equipment from the NPC Team at the Airport and transport it directly to the storage at JLN Stadium for the respective teams (competition equipment cannot be brought to the Official Team Hotels).

1. The Competition Equipment will be separated and stored by country upon arrival at storage. The LOC will label the Competition Equipment.
2. The LOC Transportation Team will count the equipment and provide the NPC with a receipt.
3. It will be the responsibility of the NPC to unpack the equipment at the Equipment Storage Area.

### **2.4.2 Training/Competition Period**

Athletes must submit a request on a form (available at the Storage Area) for the transfer of equipment (from Training Venue to Competition Venue and from the Competition Venue to the Training Venue) one day before the required transfer, i.e., **before 18:00 Hrs.**

Competition Equipment can be taken to the Training Venue Storage and kept there during training/competition period however the athlete must ensure that it has been transferred to the Competition Venue in time for competition.

It is the athletes' responsibility to ensure the competition equipment is transferred from the Training Venue Storage to the Competition Storage at JLN Stadium in time for competition.

Throwing frames once used in competition will be returned to the Competition Equipment Storage at the JLN Stadium from the field of play.

### **2.4.3 Departure**

The team must pack their competition equipment at the Storage Area at JLN Stadium and submit the Airport Transport Form along with the competition equipment to the Storage Area receptionist at least one day before departure (**till 19.00 hrs**). On the day of departure, teams may pick up their competition equipment at the airport.

## 3. Accreditation

### 3.1 Accreditation Centre Check-in

---

All teams must report to the Accreditation Centre inside JLN Stadium at a location to be confirmed later. The WPA Competitions Team will confirm your entries, verify all financial matters, and complete the LOC's final checks. Upon completion of this process, accreditation badges for your team will be issued.

**NOTE: There is no reservation for the Accreditation Centre. It is on a first-come, first-served basis.**

**22-24th September: 9:00-12:00 Hrs / 14:00-17:00 Hrs**

**25 September: 9:00-12:00 Hrs**

For late arrivals, please coordinate your arrival with Irina Khapugina (WPA Competitions Coordinator): [Irina.Khapugina@WorldParaAthletics.org](mailto:Irina.Khapugina@WorldParaAthletics.org)

### 3.2 Accreditation access

---

All team members are required to always wear their Accreditation Badge to enter the official Championships/Training Venues. They should wear it in a manner that is clearly visible to security staff. An Accreditation Badge is not transferable and only permits entry to the individual for whom it is issued. Misuse of an Accreditation Badge may result in cancellation of accreditation.

#### 3.2.1 Loss of Accreditation Badge

In case of loss or theft of an Accreditation Badge, please report it immediately to the Accreditation Centre. To obtain a new Accreditation Badge, the team member must proceed to the Accreditation Centre, accompanied by his **Team Leader**, or the **highest official in the delegation**, carrying an appropriate identification document. A lost or damaged Accreditation Badge will be cancelled in the Accreditation System, and a lost Accreditation Badge will not be reactivated even if found later.

##### **Accreditation Centre opening hours:**

From September 20<sup>th</sup> to September 25<sup>th</sup>: 8:00 to 19:00 Hrs

From September 26<sup>th</sup> to October 5<sup>th</sup>: 7:00 to 21:00 Hrs

#### 3.2.2 Special Passes

World Para Athletics/LOC will provide special passes as required for the following categories:

##### **1. TIC Pass(es)**

One TIC pass per team will be distributed at the Accreditation Centre. Should athlete numbers exceed 25, WPA will issue an extra (second) TIC pass that can be handed over to the relevant person within the team.



First Name \_\_\_\_\_

Last Name \_\_\_\_\_

NPC \_\_\_\_\_

### **2. Coach Pass(es)**

Coach Passes will be used during the whole period of the Championships and are linked to the accreditation card. The Coach passes (blue colour) will be distributed at the Accreditation Centre along with team accreditation cards. An extra coach pass (purple colour) can be requested by the Team Leader at the accreditation Centre, which is subject to WPA approval. If approved, the extra coach pass can be obtained by the Team Leader at the TIC.



### **3. Doping Control Passes**

They will be distributed by the chaperones in the Post Event control when an athlete has been called for an anti-doping test following their event. The accompanying person shall return the anti-doping pass to the chaperone after completion of testing.





### 3.2.3 Personal Coach and Training Partner

“P” accreditations can be granted to personal coaches and training partners who are outside of the NPC’s official delegation and have a personal employment contract or service agreement with a specific athlete or the NPC. Each NPC can apply for “P” accreditations according to the quotas outlined in the following table at a cost of 85 EUR per pass per day.

Number of Athletes	Maximum Number of ‘P’ Accreditation Passes per NPC
1-20	1
21-30	2
31-40	3
41-50	4
50+	5

“P” accreditations shall only be used by personal coaches and training partners and are not transferrable. A “P” accreditation is limited, with no access to transport or meals, and no access to the stadium. It will only give the holder access to the training and Warm-up areas during the Championships.

## 3.3 Athlete Uniform Inspection

### 3.3.1 Championships Inspection Procedures

Upon arrival at the Championships, all Team Leaders must attend the Accreditation Centre check in.

- If a team’s uniforms have not been approved through the SDMS Uniform Inspection Tool or the Uniform Pre-Inspection process, a Uniform Inspection will be conducted during the accreditation check in process.
- Accreditation for the entire delegation will be withheld until the inspection is completed.
- Prior to the check in, an email will be sent to each Team Leader with instructions on which uniforms to bring.

If any non-compliance is identified, a World Para Athletics or LOC representative will instruct the NPC to make corrections. This includes removing or covering unauthorized or excessive branding, commercial design elements, or any political, commercial, or propaganda messaging.

Corrections must be made tastefully so that the infringing elements are fully obscured.

## 4. Accommodation

### 4.1 NPC Hotels

---

The LOC has offered NPCs a range of accommodation options that allow easy access to the competition venue and training venues. The accommodation options range from 4(★★★★) stars to 5(★★★★★) stars and provide a high level of service, including free Wi-Fi and spaces for team meetings (**additional charges may apply**). All hotels are located within approximately 30-minute drive of Jawaharlal Nehru Stadium, New Delhi.

**Each Official Team Hotel will have an Information Desk located in the lobby area.** At the desks, the accommodation team will assist you with any accommodation, catering, transport, or general queries during the event. The accommodation team will endeavour to assist teams with any early arrival/late departure requirements.

**NOTE:** The accommodation fee includes full board at the hotel, the official airport transfer (including the transfer of sports equipment), and the transport service between the hotel and the training/competition venues as a package. The fee includes all taxes, and tourism surcharges applicable in India.

**NPCs must settle any additional costs (telephone, laundry, minibar, damages, etc.) directly with the hotel front desk prior to departure — the LOC will not be responsible for any additional charges.**

**Laundry provisions will be available at or near the Official Team Hotels at an additional cost to the NPC**

In case you have any questions or need any assistance, please contact the accommodation team: [wpa25-accommodation@paralympicindia.com](mailto:wpa25-accommodation@paralympicindia.com)

## NPC Hotels

### 1. The Leela Palace, Chanakyapuri



5.2 km Approximate 15 mins

Address: Africa Ave, Diplomatic Enclave, Chanakyapuri, New Delhi, Delhi 110023

### 2. Taj Palace, New Delhi



8.5 km Approximate 20 mins

Address: Taj Palace, 2, Sardar Patel Marg, Diplomatic Enclave, Chanakyapuri, New Delhi, Delhi 110021

### 3. The Lalit, Barakhamba



6.8 km Approximate 16 mins

Address: Fire Brigade Lane, Barakhamba, New Delhi, Delhi 110001

### 4. ITC Sheraton, Saket



9.5 km Approximate 20 mins

Address: Saket District Centre, District Centre, Sector 6, Saket, New Delhi, Delhi 110017



### 5. The Hotel Ashoka, Chanakyapuri



5.6 km Approximate 16 mins

Address: 50, Niti Marg, Diplomatic Enclave, Chanakyapuri, New Delhi, Delhi 110021

### 6. The Leela Ambience Convention Hotel, Vishwas Nagar



20 km Approximate 40 mins

Address: 1, CBD, Maharaja Surajmal Marg, near YAMUNA SPORTS COMPLEX, Vishwas Nagar Extension, Vishwas Nagar, Shahdara, Delhi, 110032

### 7. Eros Hotel New Delhi



Address: EROS HOTEL, Nehru Place, New Delhi, Delhi 110019

### 8. Crowne Plaza, Mayur Vihar



Address: District Centre, 13 B, Mayur Place, Mayur Vihar, New Delhi, Delhi, 110091

### 9. Holiday Inn, Mayur Vihar



Address: District Centre, 13A, Mayur Place, Mayur Vihar, New Delhi, Delhi, 110091

### 10. The Park, New Delhi



Address: Gurudwara, 15, Sansad Marg, near Bangla Sahib Road, near VFS Visa Centre, Hanuman Road Area, Connaught Place, New Delhi, Delhi 110001



11. Le Meridian, Connaught Place



5.8 KM APPROXIMATE 20 MINS

Address: Windsor Place, Janpath, Connaught Place, New Delhi – 110001

12. Hyatt Regency, Bhikaji Cama Place



7.2 KM APPROXIMATE 20 MINS

Address: Bhikaji Cama Place, Ring Road, New Delhi - 110066, Delhi

13. The Grand, Vasant Kunj



Address: Nelson Mandela Marg, Pocket 4, Vasant Kunj, New Delhi, Delhi - 110070

14. Novotel, Sadar Bazar

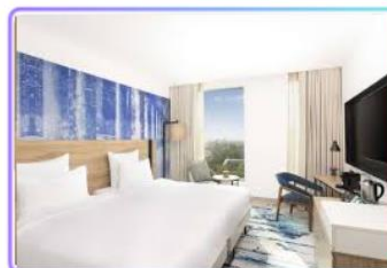

Address: Plot No. 1, Community Centre, Desh Bandhu Gupta Road, Jhandewalan, New Delhi, Delhi, 110055

## 4.2 Meals

---

Buffet-style breakfast, lunch, and dinner will be served at each Official Team Hotel from **Monday, 22 September to Monday, 6 October**. Access to all catering services at the Official Team Hotels will be granted only upon presentation of your accreditation card.

Athletes who are unable to attend the scheduled buffet lunch between 12:30 Hrs and 14:30 Hrs will be provided an extended lunch window of approximately one additional hour at their respective hotels. In cases where athletes are unable to avail themselves of the meal even during the extended period, packed meal boxes will be arranged and provided to ensure no participant misses their meal.

Two complimentary water bottles will be given to the athletes in their rooms upon arrival.

Meal service areas will be accessible for wheelchair users.

**NOTE:** Each Official Team Hotel will provide 'athlete-friendly' buffet meals. Any special dietary requirements can be arranged upon advance request.

Please send any such requests to:

[wpa25-accommodation@paralympicindia.com](mailto:wpa25-accommodation@paralympicindia.com) (additional charges may apply)

## 5. Transport

### 5.1 Transport information

---

#### 5.1.1 Airport Transfer

Transportation between the airport and the Official Team Hotels will be provided **only** to NPCs that **submit accurate and complete flight information**. Based on the details provided, the LOC transportation team will **arrange appropriately sized vehicles** to accommodate each group.

#### 5.1.2 Hotel to Training/Competition Venue

Scheduled shuttle services will operate between the Official Team Hotels and the training/competition venues. Please refer to the transportation schedule available at your hotel's front desk for specific timings and details.

### 5.2 Transport Rights on Accreditation

---

Only accreditation package holders will be permitted to board the team shuttle buses operating between the Official Team Hotels and the training/competition venues. **Please ensure to carry your accreditation card at all times.**

### 5.3 Public Transport

---

The LOC will provide transportation between the Official Team Hotels and the competition/training venue for all athletes and NPCs. The competition/training venue is also accessible via public transportation.

For further information on public transport options in New Delhi, please contact: [transport@paralympicindia.com](mailto:transport@paralympicindia.com)

**NOTE: Use of public transportation is optional. However, the LOC and transportation team will not be responsible for any delays or missed events caused by its use.**

## 6. Information Centres

### 6.1 Technical Information Centre - TIC (Competition Venue)

---

The Technical Information Centre (TIC) is located at the competition venue, near the warm-up area.

The TIC serves as the central point of contact between each delegation and the key stakeholders, including the WPA Competitions and Classification Team, the LOC, World Para Athletics Technical Delegates, and Competition Management, for all technical matters.

#### 6.1.1 Functions of the TIC:

The TIC is responsible for, but not limited to, the following:

- **Official Communications**  
Posting official notices for delegations on the designated notice board, including Start Lists, Results, and Call Room reporting times.
- **Urgent Notices**  
Distributing urgent information from Technical Delegates and Competition Management via pigeonholes. *It is the Team Leader's responsibility to check and collect these notices promptly. This information will also be shared via WhatsApp to the respective Team Leaders.*
- **Technical Meeting Queries**  
Receiving written questions for the Technical Meeting (Submission Deadline: 10:00 Hrs, 25<sup>th</sup> September) using the QR code(see section 7.1.1).
- **Forms Management**
  - Distributing Relay Confirmation Forms (to be completed and returned to the TIC)
  - Receiving Withdrawal Forms
  - Processing and Managing National Record Doping Control requests
  - Accepting Written Appeals
  - Handling Request for Assistance forms and other related documents
- **General Enquiries**  
Assisting with any general competition-related queries from delegations.

**Personal Implement check-in procedure at TIC is found under section 10.3.3**

#### Working hours

**23<sup>rd</sup> to 25<sup>th</sup> September: 09:00 to 12:00 Hrs & 14:00 to 17:00 Hrs**

**26<sup>th</sup> September to 05<sup>th</sup> October: 07:00 to 12:30 Hrs & 15:00 to 21:00 Hrs**

### 6.2 Environment Responsibility and Information Updates

---

World Para Athletics (WPA) and the Local Organizing Committee (LOC) are committed to supporting environmental sustainability. Reducing paper usage is one way we can contribute. Hence, for the Championships, **Start Lists and Results will be published exclusively on the**

**World Para Athletics website.** As part of this initiative, the amount of printed material distributed to teams via their pigeonholes at the TIC will be significantly reduced.

Competition-related information will **not** be printed for distribution in team pigeonholes. Instead, it will be:

- Updated on the Website
- Posted on the official TIC notice boards

Important notices of general interest (e.g., timetable changes) will also be available online and on the TIC noticeboard. **Only individual, team-specific communications will continue to be delivered through the team pigeonholes.**

### **6.3 Information Desks**

---

An Information Desk will be located in each Official Team Hotel. These desks will provide information and respond to queries regarding accommodation, meals, transportation, and general Championship matters (excluding technical competition-related queries, which are handled by the TIC).

The Information Desks will operate from **22<sup>nd</sup> September to 06<sup>th</sup> October**, with opening hours from **06:30 Hrs to 21:00 Hrs** daily.



## 7. Technical Meeting

### 7.1 Technical Meeting Information

---

The Technical Meeting will be held on **26<sup>th</sup> September 2025 at 10:00 Hrs** at the Zora Convention Centre. Each NPC may nominate up to **two** representatives to attend. If required, an interpreter may also be present.

The meeting will be chaired by the World Para Athletics Technical Delegates and conducted in **English**.

#### 7.1.1. Submission of Questions

All questions for the Technical Meeting must be submitted **virtually** via the Microsoft form provided below. A QR code has been provided for quick access to the form.

**Deadline:** 25 September 2025, by 10:00 Hrs (one day prior to the Technical Meeting).

**Note:** **No questions will be accepted during the Technical Meeting itself. A compiled summary of all submitted questions and corresponding answers will be distributed to participants.**

Microsoft Form Link: <https://forms.office.com/r/BJbePxjQ6J>



## 7.2 Team Leaders Orientation Visit

---

Team Leaders will have the opportunity to familiarize themselves with the venue through a tour organized by the WPA Competitions Team. **This will take place directly after the Technical Meeting on 26<sup>th</sup> September at 11.00 Hrs.**

The tour will cover the athletes' pathway from all athlete areas to the field of play, ending at the post-event control area. Directions to the Anti-Doping Area will also be provided. Attendance is strongly encouraged.



## 8. Entries and Final Confirmation

### 8.1 Entry Regulations

---

#### 8.1.1 Declaration of Participation

By completing and submitting sport entries via the **IPC Sport Data Management System (SDMS)**, NPCs confirm the participation of their athletes in the specified event(s). Athletes are required to compete in all events listed in the **Final Entries by Name Validation Report** submitted by their NPC.

Exceptions will be granted only in cases of illness or injury occurring during the Championships, in accordance with Rule 5.4 of the World Para Athletics Rules and Regulations. Any athlete found in breach of this regulation may be disqualified by World Para Athletics from **all remaining events** at the Championships (Rule 5.4).

#### 8.1.2 Athlete Programme

After entries close on 8 August 2025, athletes are subject to the Athlete Programme Regulation:

- NPCs may not enter athletes into additional events beyond those specified in the Final Entries by Name Validation Report.
- Additional event entries may be accepted **only under exceptional circumstances** at the sole discretion of World Para Athletics.
- The Athlete Programme Regulation also applies to:
  - Any proposed substitute athlete
  - Any athlete eligible for re-entry due to a change in Sport Class (Rule 5.3)

### 8.2 Final Entries

---

Final Entries must be submitted by 08 August 2025, midnight Central European Time (CET), via the IPC Sport Data Management System (SDMS)

<https://www.ipc-services.org/sdms/app/login>

### 8.3 Event Viability Criteria

---

- **Individual Events:** A minimum of **five (5) athlete entries** from **three (3) NPCs** is required for the event to remain on the medal programme.
- **Relay Events:** A minimum of **five (5) entries** from **five (5) NPCs** is required for the event to remain on the medal programme.

**World Para Athletics will review event viability after the close of the Final Entry by Name on 8 August 2025.**

### 8.3.1 Before Final Entry Deadline

If an event does not meet the above criteria by the final entry deadline, World Para Athletics may:

- Combine the event with other event(s), where appropriate and applicable.
- Cancel the event.
- Conduct the event as a **non-medal event**.

### 8.3.2 After Final Entry Deadline

If the number of entries falls below the required threshold **due to withdrawals after 8 August 2025**, World Para Athletics may still run the event as a medal event under the '**minus one**' principle:

- The event remains valid for medal distribution if at least **one fewer than the minimum required** eligible athletes remain.
- **Medal allocation as per the principle of 'minus one':**
  - **4 eligible entries** → Gold and Silver awarded
  - **3 eligible entries** → Gold awarded only
- If entries fall below these numbers, the event may still be held as a **non-medal event**, with no medals awarded.

## 8.4 Qualification Rounds

---

### 8.4.1 Seated Throw Events

If a seated throw event exceeds ten (10) **entries** at the close of final entry, a qualification round may be held to allow the competition to be conducted in a single final round.

- **Automatic Qualification:** The top Six (6) **entered athletes** (based on qualification performances) will proceed directly to the final without competing in the qualification round.
- **From Qualification Round:** The top **4 athletes** from the qualification round will proceed to the final.

### 8.4.2 Ambulant Throw and Long Jump Events

If an ambulant throw or long jump event exceeds **sixteen (16) entries** at the close of final entry, a qualification round may be held to allow the competition to be conducted in a single final round.

- **Automatic Qualification:** The top **twelve (12) entered athletes** (based on qualification performances) will proceed directly to the final without competing in the qualification round.
- **From Qualification Round:** The top **four (4) athletes** from the qualification round will proceed to the final.

### 8.4.3 Track Events

If a track event from **100m to 800m** exceeds **24 entries** (or **28 entries** for classes T11 & T12) at the close of final entry, a qualification round may be held to reduce the number of rounds to:

- **Maximum of 2 rounds** (First Round & Final), or
- **Maximum of 3 rounds** for classes T11 & T12 (First Round, Semi-Final, & Final).
- **Automatic Qualification:** The top **18 entered athletes** (based on qualification performances) will proceed directly to the first round without competing in the qualification round.
- **From Qualification Round:** The top **6 athletes** from the qualification round will proceed to the first round.

### 8.4.4 Qualification Round Timetable

#### Qualification Rounds

Date	Time	Event Name	Eligible Classes	Round
27 -Sept	09:15	Men's Shot Put F55	F54, F55	Qualifying
	17:00	Men's Club Throw F32	F31, F32	Qualifying
	18:20	Men's Javelin Throw F57	F55, F56, F57	Qualifying
28-Sept	10:32	Women's Javelin Throw F34	F33, F34	Qualifying
29-Sept	09:15	Women's Club Throw F32	F31, F32	Qualifying
01- Oct	10:18	Women's Shot Put F32	F32	Qualifying
	17:00	Men's Discus Throw F57	F57	Qualifying
03- Oct	09:15	Men's Shot Put F57	F56, F57	Qualifying
04-Oct	09:32	Men's Shot Put F34	F34	Qualifying
	10:50	Women's Long Jump T20	T20	

**Athletes will have a maximum of three trials in the qualification round for all field events.**

## 8.5 Final Confirmations

### 8.5.1 General

1. Teams will receive their **Final Confirmation Forms** prior to the Technical Meeting.
2. Team Leaders (or their designated representatives) must:
  - o Verify the accuracy of all details on the form — including **events entered, name, and sport class**.
  - o Return the completed and signed form to **World Para Athletics (WPA) immediately at the end of the Technical Meeting**.

### 8.5.2 Withdrawals

1. Any withdrawals after arrival in New Delhi must be submitted to the TIC using the official Withdrawal Form.

2. The reason for withdrawal must be clearly stated, in accordance with Entry Regulations 8.1.
3. Acceptance of the withdrawal is at the discretion of the Technical Delegates, in consultation with the Medical Delegate.

## 9. Training, Warm-up, and Competition Venues

### 9.1 Training Venues

There are two training venues located separately.

**1. Commonwealth Games Village (CWG Village)** Sports Complex, Patparganj Road, near Akshardham Temple, Pandav Nagar, New Delhi-110092

**Athletes from the following hotels will train at this venue:**

1. The Lalit, Barakhamba
2. The Leela Ambience Convention Hotel, Vishwas Nagar
3. Crowne Plaza, Mayur Vihar
4. Holiday Inn, Mayur Vihar
5. ITC Sheraton, Saket
6. The Park, Connaught Place
7. Le Meridian, Connaught Place

**2. Thyagraj Stadium**, New Prem Nagar, Laxmi Bai Nagar, New Delhi-110023

**Athletes from the following hotels will train at this venue:**

1. The Leela Palace, Chanakyapuri
2. Taj Palace, Chanakyapuri
3. The Grand, Vasant Kunj
4. Novotel, Jhandewalan
5. Eros Hotel, Nehru Place
6. Hotel Ashok, Chanakyapuri
7. Hyatt Regency, Bhikaji Cama Place

#### 9.1.1 CWG Village

The training venue facilities, schedule, and layout of the venue are as follows.

##### Facilities

- 8-lane 400m warm-up track
- 2 circles for Shot put
- 2 discus throw circles with cage
- 1 Javelin throw runway
- long jump pits.
- Seated throwing platforms

##### Schedule

Date	Time
23rd to 26th September (Pre Competition)	9:00 to 18:00
27th September to 5th October (In Competition)	9:00 to 19:00

## Stadium Layout

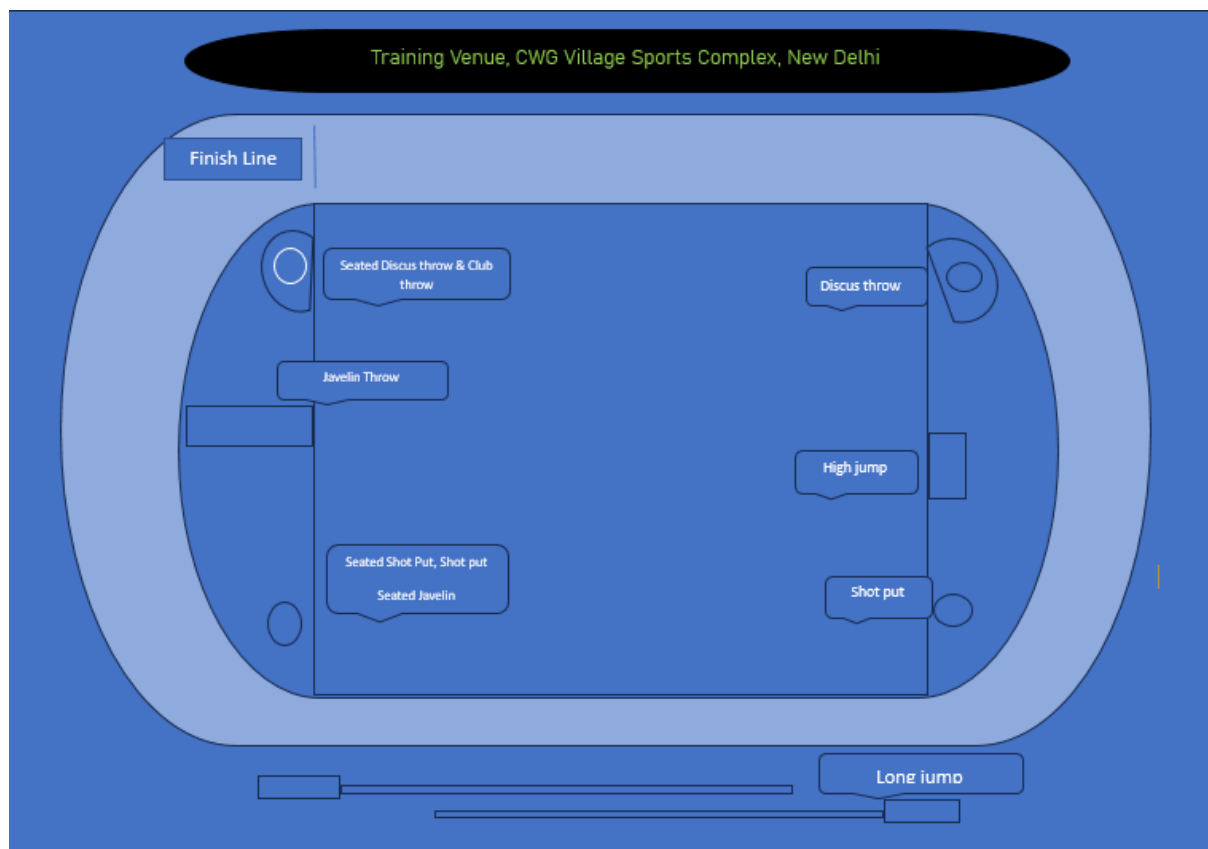

### 9.1.2 Thyagraj Stadium

The training venue facilities, schedule, and layout of the venue are as follows.

#### Facilities

- 8 Lane Track
- 1 standing discus circle
- Long jump pit
- Seated throwing platforms
- 1 High jump pit

#### Schedule

Date	Time
23rd to 26th September (Pre Competition)	9:00 to 19:00
27th September to 5th October (In Competition)	7:00 to 20:00

## Stadium Layout

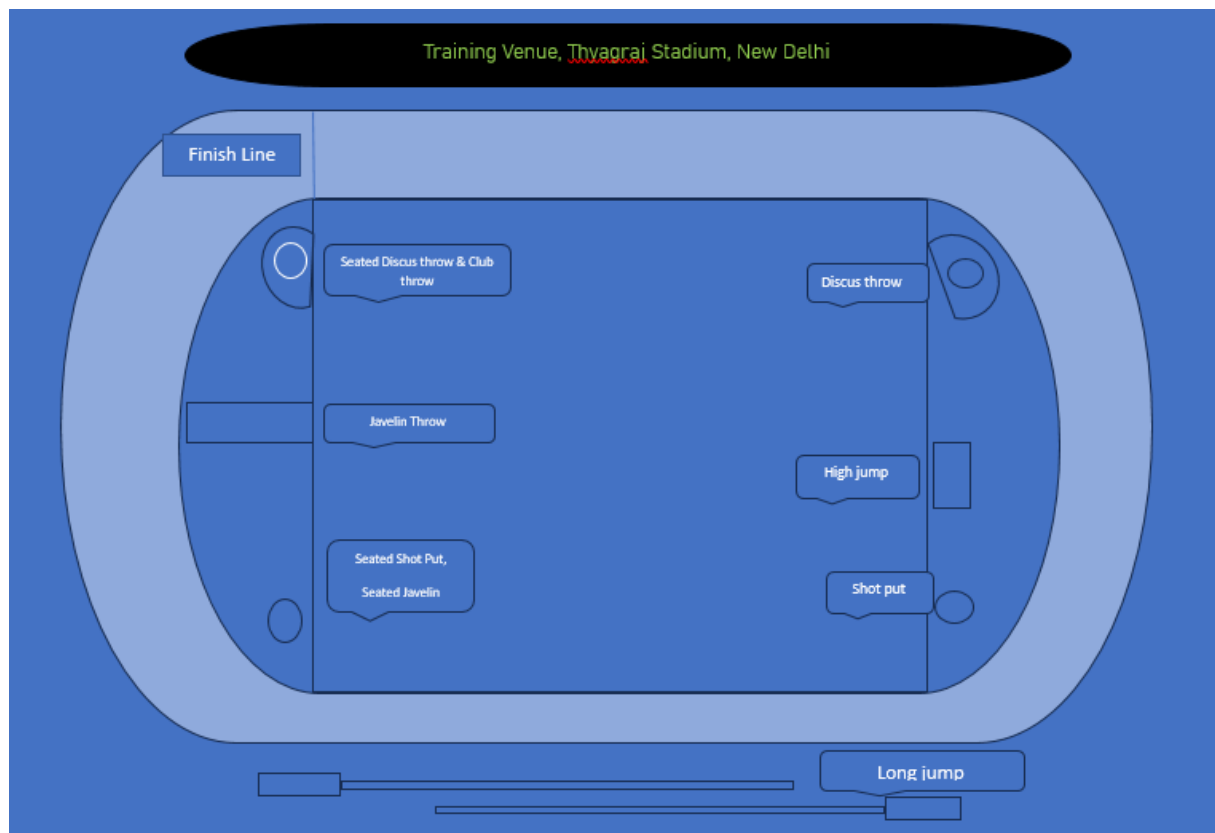

## 9.2 Warm-up Area

1) The warm-up area is located right next to the main stadium. The warm-up facilities are as follows.

- 9-lane 400m Mondo warm-up track
- 4 long jump pits
- High jump mat
- Shot put circles
- Discus throw circle with cage
- Seated throwing platforms



## Warm-up track layout

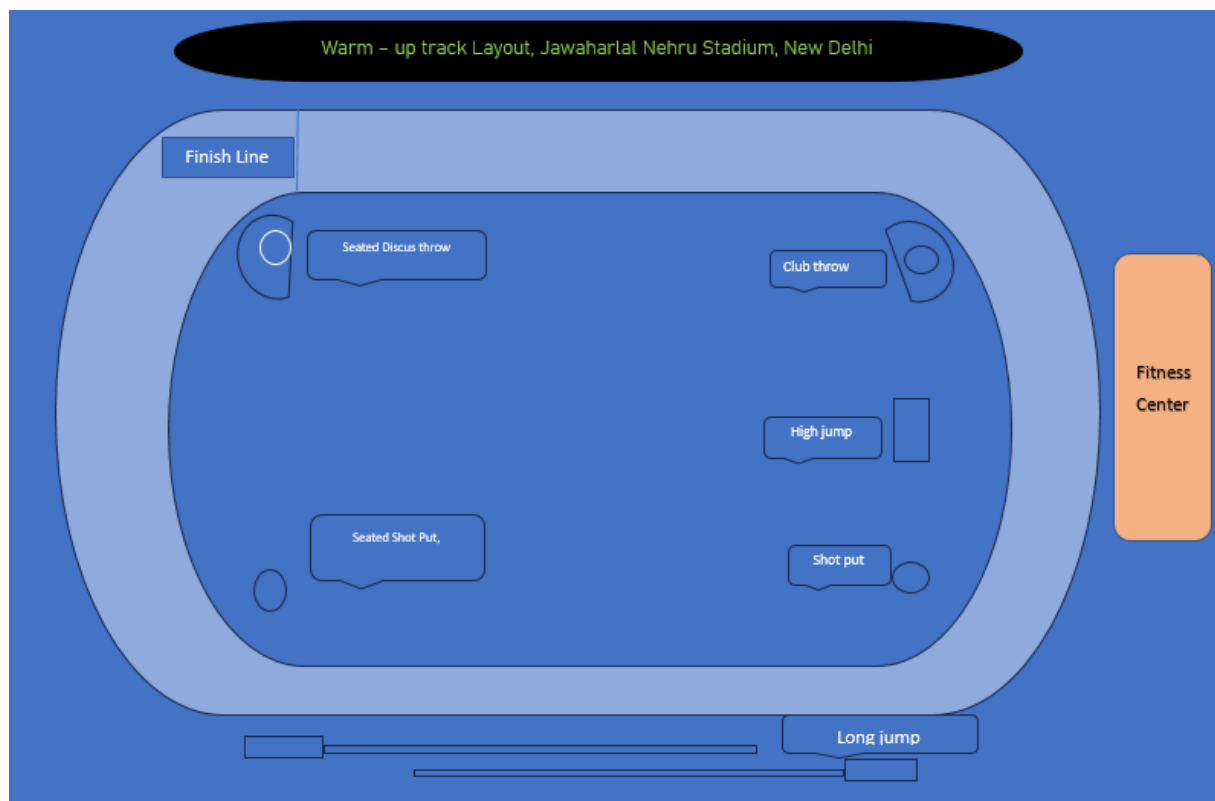

2) The **long throws warm-up area** for throwing events is also located near the warm-up track. It has the following facilities:

- 2 Javelin runways
- 1 discus circle with cage
- 4 seated javelin throwing platforms

## Long throw Warm-up Area

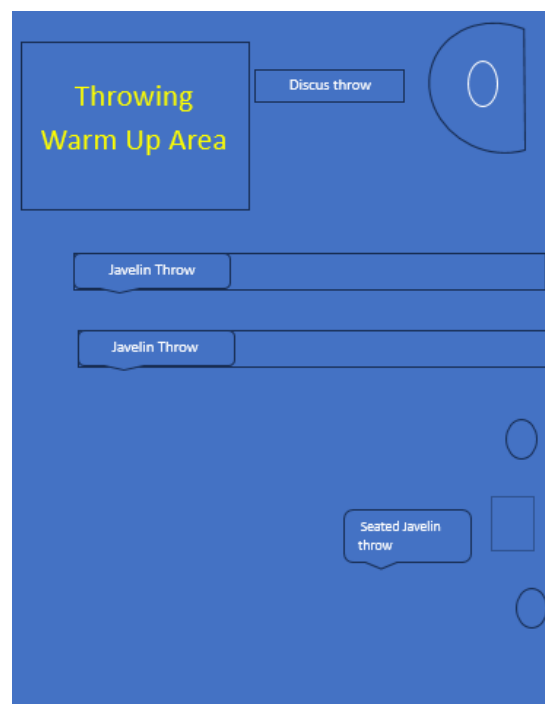

### 9.2.1 Warm-up times at the Jawaharlal Nehru Stadium

During competition days, the warm-up area will open **2.5 hours prior to the start of each session** and will be accessible **only to athletes scheduled to compete in that upcoming session**.

Session timings are as follows:

**27<sup>th</sup> September to 05<sup>th</sup> October: 6:30 to 11:30 Hrs & 14:30 to 20:00 Hrs**

### 9.2.2 Starter's Practice in Competition Venue

**Warm-up for Starters Practice: 25<sup>th</sup> September**

*Wheelchair – 08:00 - 09:00*

*Frame Runner – 8:45 – 09:15*

*Ambulant – 09:15 – 10:15*

*T11 and T12 – 10:15 – 11:00*

***Starters Practice: 25<sup>th</sup> September***

*Wheelchair – 09:00 – 09:45*

*Frame Runners – 09:45 – 10:15*

*Ambulant – 10:15 – 11:00*

*T11 and T12 – 11:00 – 11:30*

**Please note that no warm-up will be permitted inside the competition stadium, regardless of the event in which you are competing.**

**For wheelchair roller training, an area will be set up in a tent in front of the competition venue, not on the warm-up track. Six rollers will be available inside the tent for practice, but each team may also use their personal rollers.**

### 9.2.3 Team Tents

Team tents will be located at the warm-up track and will be **shared among multiple countries**. All teams are requested to be considerate and ensure the tents are used **fairly and in an equitable manner** by everyone.

### 9.2.4 Repair Services

The official Championships repair services, **available for free** to all teams competing at New Delhi JLN stadium, will be provided by **Ottobock**.

Teams can bring their equipment during opening hours to the Repair Service Centre to request repairs. The Centre will be located at the competition venue - Jawaharlal Nehru stadium, next to the team tents.

### Working hours

**23<sup>rd</sup> & 24<sup>th</sup> September: 7:30 to 21:00 Hrs**

**25<sup>th</sup> & 26<sup>th</sup> September: 7:30 to 19:00 Hrs.**

#### **Note:**

- **Top priority** will be given to ensuring athletes have competition-ready equipment in time for their events.
- Priority will be placed on restoring equipment to its **original condition**.
- Repairs to **interfacing parts** in contact with the body will take precedence.
- Repairs for **daily-use welfare equipment** may also be carried out.
- The **order of return** may vary depending on the competition schedule and nature of the repairs.

#### **Not Eligible for Repair Service:**

- Requests for adjustments intended to **enhance performance** rather than restore function.

### Repair Procedure

#### **Reception**

1. Consult the reception staff to confirm the details of your repair request. A repair application sheet will be prepared, including:
  - Athlete's name
  - NPC
  - Equipment name
  - Nature of repair
  - Repair number
  - Emergency contact details
2. Receive your **repair ticket**, which includes the repair number and estimated completion time. **Keep your repair ticket safe** — it will be required to collect your equipment after the repair.

#### **Procedure (Return)**

1. Present your repair ticket to the reception staff.
2. A staff member will guide you to the **test/try-on area**.
3. Inspect the repaired equipment together with Repair Centre staff. If any defects are found, they will be fixed immediately.
4. Collect your equipment to complete the process.

## 9.3 Competition Venue: Jawaharlal Nehru Stadium, New Delhi

### 9.3.1 Stadium Presentation

The New Delhi 2025 World Para Athletics Championships will be held at the iconic **Jawaharlal Nehru Stadium, New Delhi**.

Originally built to host the **1982 Asian Games** and extensively redeveloped for the **2010 Commonwealth Games**, the stadium is one of India's premier multi-sport facilities. Over the years, it has hosted a wide range of events, including track and field competitions, rugby, football, concerts, and other large-scale gatherings.

For the Championships, the venue has been upgraded with a **new Mondo track surface**, ensuring world-class conditions for athletes.

### 9.3.2 Competition Stadium – Mondo Track Specifications

- 9-lane, 400m track
- 8 long jump pits
- Throwing circles, including anchor points for seated throws (2 throwing cages)
- javelin runways
- 1 high jump mat

### 9.3.3 Stadium Layout

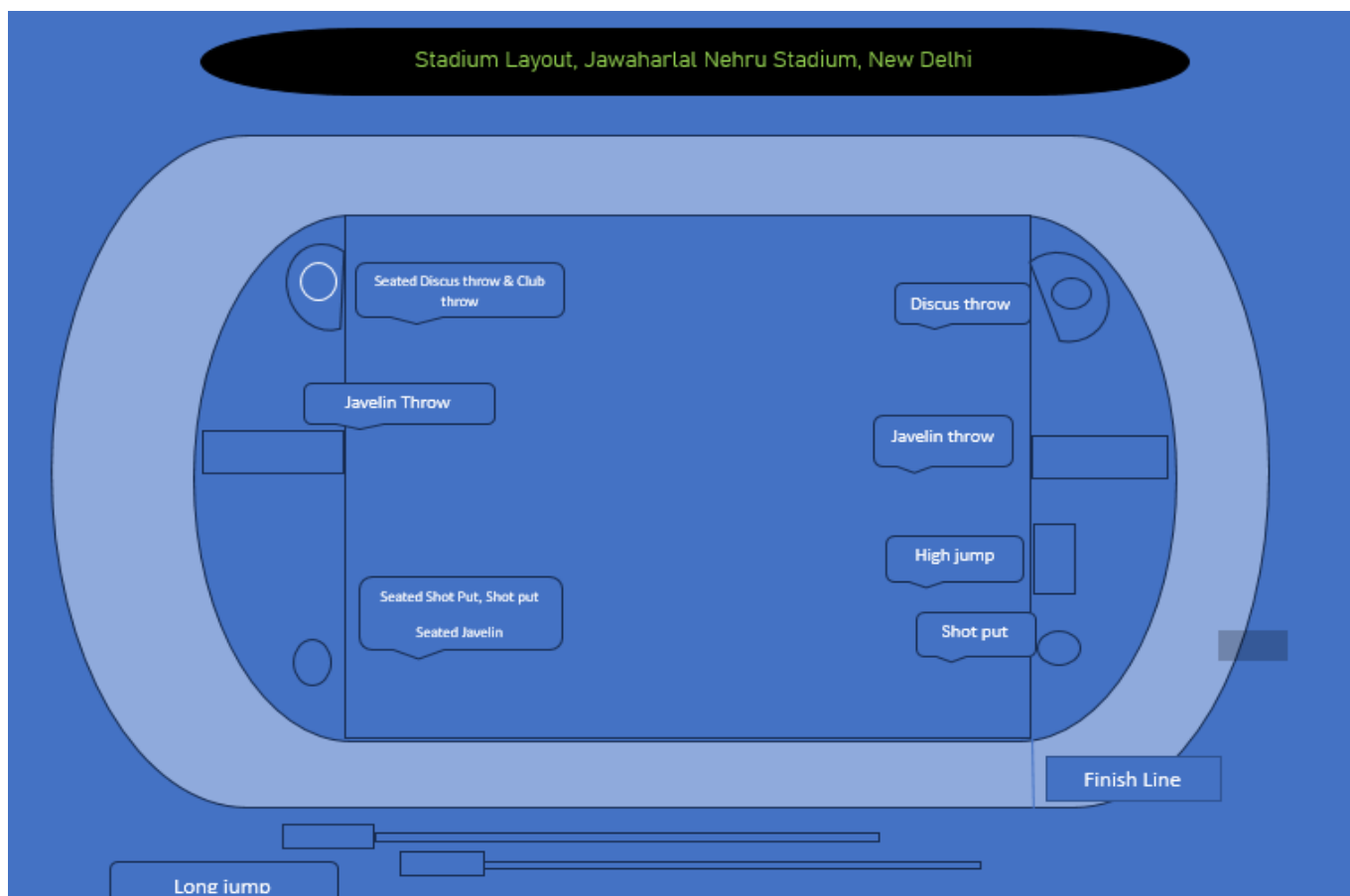

## 10. Competition Procedures, Equipment and Implements

### 10.1 Confirmation of Starting Heights, Distances and Progressions

The qualification procedures for track events — including the number of heats in each round and the method of progression — as well as the starting heights and bar increments in the High Jump, will be determined by the Technical Delegate(s). These details will be communicated to Team Leaders during the Technical Meeting. Complete documentation of the qualification procedures will also be available at the Stadium TIC.

### 10.2 Sports Equipment

#### 10.2.1 Markers

- Athletes are not permitted to use their own markers during the Championships.
- Athletes are required to use the markers provided by the LOC at the event site.
- Relay athletes will be provided with adhesive tape by officials upon exiting the Call Room.

#### 10.2.2 Official Implements

The list of Official Implements provided by the LOC will be selected from the World Athletics certified list.

Refer to **Appendix 3** for the detailed list of implements available.

#### 10.2.3 Personal Implements

Athletes may submit up to two (2) personal implements for each event in which they are competing.

Personal Implements will be permitted provided that:

- They are readily identifiable and either appear on the World Athletics certified list or meet the World Para Athletics specifications for Para Athletics weights.
- They have been checked and verified for compliance with World Para Athletics rules.
- They are made available for use by all other athletes in the same event until the conclusion of the final.

**Check in procedure is as follows:**

Checking	Location and Time	Time
Personal throwing implements are to be checked in prior to the event required to be used in. A receipt will be given for the implements.	Checked in at TIC no later than 17:00 the day before the event	Implements are returned in exchange for the receipt after the event's final at TIC. This will include any rejected implements.

**Note:** As stated in the 10 July communication to nations regarding *Non-Compliant Clubs*, we would like to reaffirm that WPA Rule 37 – Club Throw remains unchanged.

Athletes intending to use personal club implements at the New Delhi 2025 World Para Athletics Championships must ensure their equipment fully complies with the specifications and shape requirements set out in Rule 37.

The following examples show club shapes that do not conform to WPA Rules and are not permitted for use in competition:



#### 10.2.4 Equipment Checks

**A courtesy pre-check of Throwing Frames, Racing Wheelchairs, and Running Frames will be conducted at the Storage Area, JLN Stadium on 25th September at 09:00 – 11:00 AM.**

- Throwing Frames must have the athlete's bib attached to the back.
- It is the responsibility of the athlete/NPC to ensure their equipment is in the Storage Area on time.  
Athletes/NPCs may also bring tethers, eye masks, spikes or request MASH, for pre-check during this session.

### 10.3 Competition Schedule

---

The Competition schedule for New Delhi can be found using the following link:

<https://www.paralympic.org/athletics/new-delhi-2025>

The information regarding changes to the official schedule shall be provided at the Technical Meeting and through the TIC.

### 10.4 Athletes' Bibs

---

#### 10.4.1 Bibs

Each athlete will receive five (5) bibs displaying their name. These bibs, along with pins, will be distributed at the Technical Meeting. Any uncollected bibs will be transferred to the TIC. Bibs must be attached in accordance with the table below:



	Track Events	Throwing Events	Jumping Events
<b>Ambulant Athletes</b>	1 bib on back <u>and</u> 1 bib on breast	1 bib on back <u>and</u> 1 bib on breast	1 bib on breast <u>or</u> back
<b>Seated Throws</b>		1 bib on the back of throwing frame <u>and</u> 1 bib on breast	
<b>Wheelchair Racing</b>	1 bib on the back of the racing chair <u>Optional:</u> 1 helmet number <u>and/or</u> 1 bib on side of the frame		
<b>Frame Running</b>	1 bib on the back of the athlete <u>Optional:</u> 1 helmet number <u>and/or</u> 1 bib on side of the frame		

The remaining bibs are to be used on the tracksuit, the athlete's bag, and the day chair (for wheelchair track athletes) to ensure ease of identification.

**All bibs must be worn in accordance with World Para Athletics Rules and must not be cut, folded, or obscured in any way. Failure to comply may result in disqualification and/or sanction. Additionally, to prevent any unsporting messages, no writing or alterations are permitted on any part of the bibs.**

#### 10.4.2 Relays

Relay bibs displaying the country code (e.g., *IND*), which must be worn on the front, will be provided at the Call Room. Athletes must also wear their personal bib on the back.

For wheelchair relay events, athletes will wear only the bib with the country code on the back of their racing chair.

#### 10.4.3 Hip Numbers

Athletes participating in Track Events will be provided with **two adhesive lane/position numbers** at the Call Room prior to entering the Field of Play. These numbers must be securely affixed to **both sides** of the athlete's shorts, legs, or helmet, as appropriate.

### 10.5 Athlete Uniform Inspection During Competition

At the Call Room, within the Field of Play, and prior to Victory Ceremonies, Technical Officials (TD, ITO, NTO), World Para Athletics staff, and LOC staff will ensure that all athletes and team officials comply with the Uniform and Equipment Regulations.

- Any observed infraction will be reported through the appropriate chain of command.
- Non-compliant uniforms, equipment, or accessories must be corrected before the athlete may compete or take part in ceremonies.
- Failure to comply may result in the athlete's disqualification.

## 10.6 Call Room

The first Call Room is located near the Warm-up track by the Stadium. All athletes, guide-runners and assistants will use this Call Room.

### 10.6.1 Personal Belongings

In accordance with Call Room procedures, a strict inspection will be conducted for illegal or prohibited items in athletes' possession. Electronic devices (e.g., radios, tablets, mobile phones, smart watches, cameras) are not permitted. Any items that do not comply with the World Para Athletics Technical and/or Advertising Rules and Regulations will be confiscated. Confiscated items may be collected from Post Event Control after the competition.

- Track athletes must enter the Field of Play ready to compete; personal belongings can be retrieved from Post Event Control.
- Field athletes may carry only a backpack or similar-sized bag onto the Field of Play.

### 10.6.2 Throwing Frame Check in

**The movement and storage of equipment is detailed under 2.4**

It is the responsibility of the athlete/nation to ensure that all equipment is placed in the designated storage area prior to their event.

**Throwing Frames** must be delivered to the Storage Area for Call Room inspection **60 minutes prior to the first Call Room entry time**. After inspection, they will be kept secure and transferred to the competition site by officials. Upon completion of the event, they will be returned to the Storage Area.

**Racing Chairs** and **Frame Running Frames** must be taken directly to the Call Room by the athlete, in accordance with the Call Room Schedule, where they will be inspected by Call Room staff.

### 10.6.3 Call Room Reporting Times

All athletes will be required to report to the Call Room according to the scheduled reporting times.

The Call Room schedule is as follows:

<b>Track Events</b>	<i>35 minutes</i>
<b>Seated Throws</b>	<i>35 minutes</i>
<b>Ambulant Throws</b>	<i>50 minutes</i>
<b>Jump Events</b>	<i>50 minutes</i>

A detailed schedule of all call times will be published in advance every day and will be displayed at TIC, warm-up track and at the Call Room.

**Note:** In accordance with Rules 5.4 and 5.5, an athlete shall be excluded from participation in any event if they are not present in the Call Room(s) at the relevant time as published in the Call Room schedule. Such exclusion will also apply to all further events.

**Throwing Frames will be checked at the Storage area 60 minutes prior to the first Call Room entry time.**

#### **10.6.4 Call Rooms Procedures**

In the Call Room the following checks will be carried out:

- Identification of athletes by means of their accreditation and bib name.
- Checking the athlete's uniform
- Inspection of personal belongings
- Measurement and checking of racing chairs, throwing frames and running frames.
- Maximum Allowable Standing Height (MASH) measurement of athletes.
- Checking eye masks, eye patches and tethers
- Checking shoe or prosthesis spikes (number, shape and size).

**Pyramid and compression tier spikes are permitted in the following sizes:**



- 6mm in all areas
- Up to 9mm in the javelin and high jump areas

**If they do not comply, athletes will be asked to change them to the correct size.**

**The same procedure will apply for guide-runners and assistants accompanying an athlete into the Call Room. Guide-runners and assistants will receive their vest in exchange for their accreditation card. This card will be returned at Post Event Control upon return of the vest.**

**Teams must ensure that all athletes and their equipment comply with the Rules before entering the Call Room to avoid delays.**

**Accreditation cards for competing athletes, guide-runners, and assistants will be collected in the Call Room and returned at Post Event Control.**

**After completing these procedures, athletes, guide-runners, and assistants must follow the instructions of the officials in the Final Call Room before being escorted onto the Field of Play (FOP).**

#### **10.7 Entry onto Field of Play**

---

All athletes, guide-runners, and assistants shall enter the Field of Play accompanied by competition officials, as directed. During an event, no athlete or assistant may leave the competition area without the permission of the Chief Judge. If it becomes necessary to leave, an official will escort the individual.

Sealed water bottles will be provided to all athletes in the competition area.

## **10.8 Specific Event Procedures**

---

### **10.8.1 Track Events**

#### **Starting Blocks**

Athletes in Sport Classes T11, T12, T13 & T20 must use starting blocks.

**No personal starting blocks are allowed.**

#### **Strobe Lights**

Strobe Lights will be available, but athletes/Teams must put in a request 24 hours prior to their event on the Request for Assistance form. Stating the following:

- Athlete's name and Sport Class
- NPC
- Event
- Time of event

**The Starters commands will be given in English**

#### **Track Usage**

Lanes 2 to 9 will be used for all events run entirely in lanes.

Lanes 1, 3, 5, and 7 will be used for all T11, T12, and Universal Relay events.

#### **Wheelchair Races (200m and above)**

Upon entering the Field of Play (FOP), athletes will be permitted to complete one lap or part off before proceeding to the starting line to set their compensators.

### **10.8.2 Vacant positions due to withdrawals in Track Semi-Finals and Finals**

Reserve athletes will be used to fill vacant positions in the Semi-finals and Finals of Track Events. These athletes will be clearly indicated in official documents (e.g., results, start lists) using the annotation "**Res**".

Reserve athletes may be deployed to fill vacant lanes in the following situations:

- Athlete does not report to the Call Room (Rule 5.4 b).
- Athlete arrives late to the Call Room (Rule 5.5.5.1).
- Medical withdrawal.
- Athlete's equipment is non-compliant (Rule 6.16), including failure in MASH verification testing.
- An athlete's equipment suffers a mechanical malfunction that cannot be rectified before athletes leave the Call Room for the Field of Play (FOP).

### 10.8.3 Field Events Trials

#### Qualifying Events

During the competition sessions, certain events will serve as qualifying rounds. The following regulations apply:

- **Horizontal Jumps & Ambulatory Throws:** The competing order for the final three rounds of trials will be in reverse ranking order based on results from the first three rounds. After the fifth round, the order will be reversed.
- **Seated Throws:** There will be no reversal of the throwing order. All athletes will be given six (6) attempts.
- **Events Requiring a Qualification Round:** Qualification for the final will follow the **Qualification Regulations** (refer to the Qualifications section).
- **Number of Attempts in Qualification Rounds:** All qualification rounds will allow three (3) attempts per athlete.

### 10.8.4 Guide-runner Substitution

Guide runner substitutions are permitted during competition only if the original guide withdraws due to injury, illness, or other exceptional circumstances.

- In the case of illness or injury, a **medical certificate** signed by the team/LOC medical doctor must be submitted to World Para Athletics for approval.
- Substitutions may only be made **within the entered NPC team**.
- World Para Athletics must receive an **official request** from the NPC along with all supporting documentation.

### 10.8.5 Sport Class Changes and Re-entry Regulations

If an athlete's Sport Class changes during the **Classification Evaluation Period** and/or the **In Competition Observation Period**, re-entry may be considered in line with **Rule 5.3**, subject to approval by the Technical Delegate(s).

### 10.8.6 Relays

1. The **final composition** of relay teams and the **order of running** must be officially declared at the TIC **no later than one hour before the first published Call Room time** for the first heat of each round.
2. **Declaration Forms** will be available at the TIC on the day of the event.
3. Changes for **medical reasons** (verified by the WPA Medical Delegate) may be made, up to the **final Call Room time** for the relevant round.
4. This declaration must be submitted at the **Stadium TIC**, where an official will be available at designated times for this purpose.
5. The team must compete as declared.
6. After competing in a round, a maximum of **four additional athletes** may take part in the final. Substitutes must come from the **list of entered athletes** in the respective event.

### 10.8.7 Failure to Participate

1. Any athlete who, after Final Confirmation has been submitted, or after qualifying in a heat /qualification round, fails to participate without a valid reason will be excluded from remaining events in the competition, including relays.
2. Valid reasons include, for example, a medical certificate issued by the official doctor of the Championships.

### 10.8.8 Coaching Zone

Dedicated seating will be provided in appropriate areas for Field Event Coaches. These will be accessible by means of accreditation along with a coaches seating pass which is available from TIC prior to the event.

Appropriate arrangements will be made for a coaching zone during seated throwing events. These will be detailed at the Technical Meeting.

## 10.9 Timing and Measurement

---

Official timing and measurement will be provided by ATOS.

## 10.10 Post Competition Procedures

---

After completing their event, athletes will exit the Field of Play via the Mixed Zone, located immediately after the finish line. In the Mixed Zone, accredited media may conduct brief interviews.

Once through the Mixed Zone, athletes proceed to **Post Event Control (PEC)**, where they can collect their clothing, personal belongings, and accreditation.

**Team Leaders** with a special pass may access the end of the PEC to check whether their athlete has been selected for doping control. If the athlete has been called for testing, the Team official receive a **Doping Control Pass** from the chaperone in order to accompany the athlete to the testing area.

### 10.10.1 Doping Control

Athletes selected for doping control will be personally notified and accompanied by a chaperone or Doping Control Officer to the Doping Control Station area as soon as practically possible after the conclusion of their event. An athlete may be accompanied by a representative of their choice plus an interpreter, if required.

## 10.11 Technical Protests and Appeals

---

Protests and Appeals will be handled according to World Para Athletics Rules and Regulations March 2024 and shall be handled by Technical Information Centre.



#### 10.11.1 Protests

- The TIC is responsible for recording the time the official result is announced.
- A protest may be lodged by:
  - The athlete,
  - Someone acting on the athlete's behalf, or
  - An official representative of the team.

Eligibility: Only athletes/teams competing in the same round of the event may protest.

#### Procedure to protest:

- First the athlete should Protest orally to the Referee on the FOP
- If not, then within 30 minutes of the official results being published.
- The Referee will either decide on the protest or can refer the matter to the Jury of Appeal.
- If the Referee is unavailable, the protest may be recorded on the appropriate form at TIC within the 30-minute window.

If the Referee's decision is not accepted, the athlete/team has the right to appeal to the Jury of Appeal within 30 minutes of the Referee's decision being made.

#### 10.11.2 Appeals

- An appeal to the Jury of Appeal must be submitted within 30 minutes:
  - From the official announcement of an amended event result, or
  - From the Referee's decision (or when notified of it), even if no result change occurs.
- Requirements:
  - Must be in writing,
  - Signed by a responsible Team Official, and
  - Accompanied by an appeal fee of €200.
- Note: The appeal fee will be forfeited if the appeal is not upheld.
- Only athletes/teams competing in the same round of the event in question may appeal.

**Note: The relevant Referee shall, after deciding on a protest that has been lodged at TIC will immediately inform the TIC of the time of the decision. If the Referee was unable to communicate this orally to the relevant team(s)/athlete(s), the official time of the announcement will be that of posting of the amended results or of when decision is given to the TIC.**

**Team Leaders must bring their organisation's Credit card as Appeal payments will be done via Credit card payments.**

### 10.12 Victory Ceremonies

---

#### Medal Allocation

- The **first three athletes** in each individual event (including guide-runners) and the **first three teams** in each relay will receive **gold, silver, or bronze medals** respectively, in accordance with the event viability criteria and the *World Para Athletics Rules and Regulations March 2024*.

- As per the rule 52.2 of the WPA technical rules and regulations, athletes shall nominate the guide-runner(s) on the final entries. Only those guide-runners who have been declared by the final confirmation and who meet the following criteria shall be eligible to receive a medal alongside the medal winning athletes.
- In individual events where athletes with vision impairment are allowed to compete using multiple guide-runners, only those guides who have completed the full event (from the first round to finals) with the athlete shall be eligible to receive the medal alongside the athlete.

Note (i): Assistants in field events are not eligible to receive a medal.

Note (ii): Should the athlete declare to use more than one guide-runner in an event, then these guide-runners will not be eligible to receive a medal.

- If a relay team uses more than four athletes across the heats and final, **only the four athletes** (plus guide-runner, if applicable) who competed in the final will be awarded medals during the official ceremony. The other eligible athletes/guide-runners will receive their medals later at the **Team Information Centre (TIC)**.

#### Location & Timing

- All ceremonies will take place at the Medal Plaza on the Medal Plaza stage.
- Morning session medalists will receive their medals **the same afternoon commencing at 16:00pm**.
- Evening session medalists will receive their medals **the following morning commencing at 11:30am**.
- Medals for the final evening session will be awarded **during that session** at the Medal Plaza.

#### Procedure

- After competition, LOC staff will gather the top three athletes/teams at **Post Event Control** and provide them with a letter detailing the **time to report to the Green Room** for their ceremony.
- **The Green Room is located near the medal plaza.**
- Athletes must be present at the time stated. Ceremonies will not be delayed for late arrivals.
- If an athlete is absent, the ceremony will proceed without the athlete and the **Team Leader** can collect the medal at the TIC at the end of the competition day.

Medalists may not delegate the receipt of their medal to anyone else during a ceremony.

#### Dress & Conduct Requirements

- Athletes and guide-runners must wear their **official delegation uniform** during the ceremony.
- Championship bibs, provided in the waiting area before the ceremony, must be worn.
- During the anthem and flag raising, medalists must face the flags and maintain a **dignified demeanor**.
- National flags or other personal items are **not permitted** on the podium.

### **Additional Access**

- Each athlete may be accompanied by one member of team management to the Medal Plaza.

**A provisional Victory Ceremonies schedule is available in (Appendix 4).**

## 11. Classification

### 11.1 NPC Responsibilities

---

It is the collective responsibility of each Athlete and their NPC, through the NPC Team Leader and relevant Team Officials, to be informed about and comply with all Classification policies and procedures of the Championships, as outlined in the World Para Athletics Classification Rules and Regulations:

[World Para Athletics Classification & Regulations \(paralympic.org\)](https://www.paralympic.org)

Each NPC is responsible for ensuring the Athletes be present at the Classification Area 30 minutes prior to the scheduled time specified in the Classification Schedule for evaluation.

### 11.2 Sport Class Status

---

A Sport Class Status indicates whether or not an Athlete will be required to undertake Athlete Evaluation.

Athletes with a Sport Class Status of New (N) or Review (R) (not including athletes with a fixed date review beyond 2025) will be required to undertake Athlete Evaluation upon arrival at the New Delhi 2025 Para Athletics World Championships.

### 11.3 Pre-Championships Classification Activities

---

#### 11.3.1 Classification Master List

Each NPC is responsible for verifying the Sport Class data of their athletes. NPCs should refer directly to World Para Athletics if the Classification Master List contains incorrect athlete data (name, Sport Class, Sport Class Status) and/or if an athlete is not included on the Classification Master List.

#### 11.3.2 Classification Evaluation Schedule

The Classification Schedule will be shared via the website (<https://www.paralympic.org/athletics/new-delhi-2025>) to NPC's after the final entry deadline.

The schedule will include all athletes that must be present for classification upon arrival at the New Delhi 2025 Para Athletics World Championships.

If an athlete is classified at a World Para Athletics International Classification event after the final entry deadline but before the Classification Evaluation Period begins at the New Delhi 2025 Para Athletics World Championships, the Classification Schedule may need to be adjusted. Any changes will be reflected on the Classification Schedule and will be communicated to the respective NPCs via email.

## 11.4 In-Competition Classification Activities

---

### 11.4.1 Classification Evaluation Period

Athletes with a Sport Class Status of **New (N)** or **Review (R)**, except those with a fixed review date beyond 2025, must complete Athlete Evaluation upon arrival at the New Delhi 2025 Para Athletics World Championships.

It is the responsibility of each NPC, through their Team Leader, to ensure that all athletes listed on the Classification Schedule are available at the designated venue, date, and time. Athletes must arrive at least **30 minutes before** their scheduled Evaluation Session, bringing:

- A valid passport
- Required competition equipment and attire
- Any necessary medical documentation as outlined in the World Para Athletics Classification Rules and Regulations

Failure to follow the Athlete Evaluation process, as stated in the Classification Rules, may result in the athlete being ineligible to compete.

Athletes may be accompanied by an Athlete Support Personnel who must be a member of the athlete's National Body or National Paralympic Committee. For underage athletes, a Support Personnel is mandatory. Evaluations will be conducted in English. If the athlete does not speak English, a translator may attend as an additional person.

Before the evaluation, athletes and their Support Personnel must sign the **Athlete Evaluation Agreement Form** provided by World Para Athletics.

The Classification Panel will verify athlete identity through a valid passport, birth certificate, or official ID.

### 11.4.2 Classification Competition Period – Observation in Competition

A Classification Panel may require an athlete to undergo Observation Assessment in Competition before confirming their final Sport Class and Sport Class Status. If this happens, the procedures outlined in Article 14 of the World Para Athletics Classification Rules and Regulations will apply.

Athletes required to complete Observation Assessment in Competition will be assigned the Tracking Code "OA" (Observation Assessment), which temporarily replaces their Sport Class Status for the duration of the assessment.

Observation Assessment in Competition is usually conducted during the athlete's **First Appearance** in that Sport Class.

- **First Appearance** is the first time an athlete competes in any event within a particular Sport Class during a competition.
- This applies to all events within the same Sport Class.

Once the First Appearance (or any Observation during a Protest) is complete, the Classification Panel will assign the athlete's Sport Class and Sport Class Status, replacing the "OA"

designation. Any changes to an athlete's Sport Class or Sport Class Status take effect immediately.

If the Classification Panel does not observe the athlete's First Appearance, the athlete's NPC will be informed of the next steps. This may include conducting the Observation Assessment at the athlete's next scheduled competition.

### 11.4.3 Sport Class Changes

Should an Athlete's Sport Class change during the Classification Period and/or the Classification Competition Period, re-entry may be considered in line with World Para Athletics Rules and Regulations (March 2024) Rule 5.3 and are subject to approval by the Technical Delegate(s).

Advisement of re-entry will be available at TIC after consideration by the Technical Delegate(s).

### 11.4.4 Change of Class during Competition

During the competition period, the Sport Class of an Athlete may change after **Observation in Competition** or **Classification Protests** and may affect an Athlete's Sports Class, result(s), placing and record(s) at the competition in accordance with **Rule 52.4** of the World Para Athletics Rules and Regulations March 2024.

## 11.5 Classification Protests

Only athletes listed on the Classification Schedule can be protested by their own NPC. This is called a **National Protest**. World Para Athletics may protest the classification of any athlete, regardless of their Sport Class Status.

National Protests must follow the process outlined in Article 22 of the World Para Athletics Classification Rules and Regulations. A Protest fee of **€150** must be paid on site by credit card.

- The fee will be refunded only if the protest is successful and the athlete's Sport Class changes.
- The fee will not be refunded if the protest is upheld but the Sport Class remains the same.

Protests may only be submitted by the authorized individuals listed in the table below:

<i><b>Protests during Classification Period (Physical and Technical Assessment)</b></i>			
<b>Sport Class Status at Final Entry</b>	<b>Protest by Athlete's NPC (National Protest)</b>	<b>Protest by Other NPC</b>	<b>Protest by WPA</b>
<b>New (N)</b>	Yes	No	Yes
<b>Review (R)</b>	Yes	No	Yes
<b>Confirmed (C)</b>	No	No	Yes
<i><b>Protests during Classification Competition Period (Observation Assessment)</b></i>			
<b>Observation Assessment (OA)</b>	Yes	No	Yes



### 11.5.1 National Protest Deadlines

National Protests must be submitted by an authorized NPC representative to the TIC or directly to the Chief Classifier within the specified time limits. If World Para Athletics lodges a protest, the NPC will be informed both verbally and in writing, and will be given the time and date for any required re-evaluation.

Classification Phase		Time of Classification Outcomes Posted	Protest Deadline Window
Classification Period (Physical and Technical Assessment)		Following each Classification Session (Morning/Afternoon)	No later than one hour after the Classification Outcome was posted
Classification Completion Period (Observation Assessment)		As soon as possible after the completion of the event in which a First Appearance occurred	No later than 15 minutes after the Classification Outcome was posted

#### ***Protests During the Classification Period (Physical and Technical Assessment):***

A Classification Protest during the Classification Period must be submitted within one hour of the publication of the Classification Outcomes. Only protests lodged after the outcomes are posted and within this deadline will be considered.

#### ***Protests During the Classification Competition Period (Observation Assessment):***

For an athlete with Tracking Status “OA” (Observation Assessment), a protest must be submitted within 15 minutes of the Classification Outcome being published after the event in which the athlete’s First Appearance occurred. The protest must be submitted at the TIC or directly to the Chief Classifier.

If a National Protest is accepted, the Chief Classifier, with full cooperation from the relevant NPC, must resolve the protest as quickly as possible to minimize any impact on the competition.

### 11.5.2 World Para Athletics Protests

World Para Athletics may, at its discretion, make a Protest at any time in accordance to the World Para Athletics Classification Rules and Regulations.

## 11.6 Classification Appeals

An Appeal is a formal objection to the way Athlete Evaluation or Classification procedures have been carried out.

Only the following bodies may submit an Appeal:

- A National Body
- A National Paralympic Committee (NPC)

If a National Body or NPC believes that procedural errors have occurred in the allocation of a Sport Class or Sport Class Status, resulting in an incorrect classification, it may lodge an Appeal.

The **Board of Appeal of Classification (BAC)** will serve as the hearing body for all appeals. Appeals must be submitted and resolved in accordance with the BAC Bylaw

## 12. Medical Services

### 12.1 Competition Venue

---

The **Medical Centre**, located at **P1, TIC** on the ground floor of the stadium, will be available to all athletes with injuries or acute illnesses requiring medical attention.

The Centre will operate from **30 minutes before the start of warm-up** until **30 minutes after the end of competition**.

To ensure quick response to any incidents on the field of play, medical and first aid stations will be positioned at strategic points around the field.

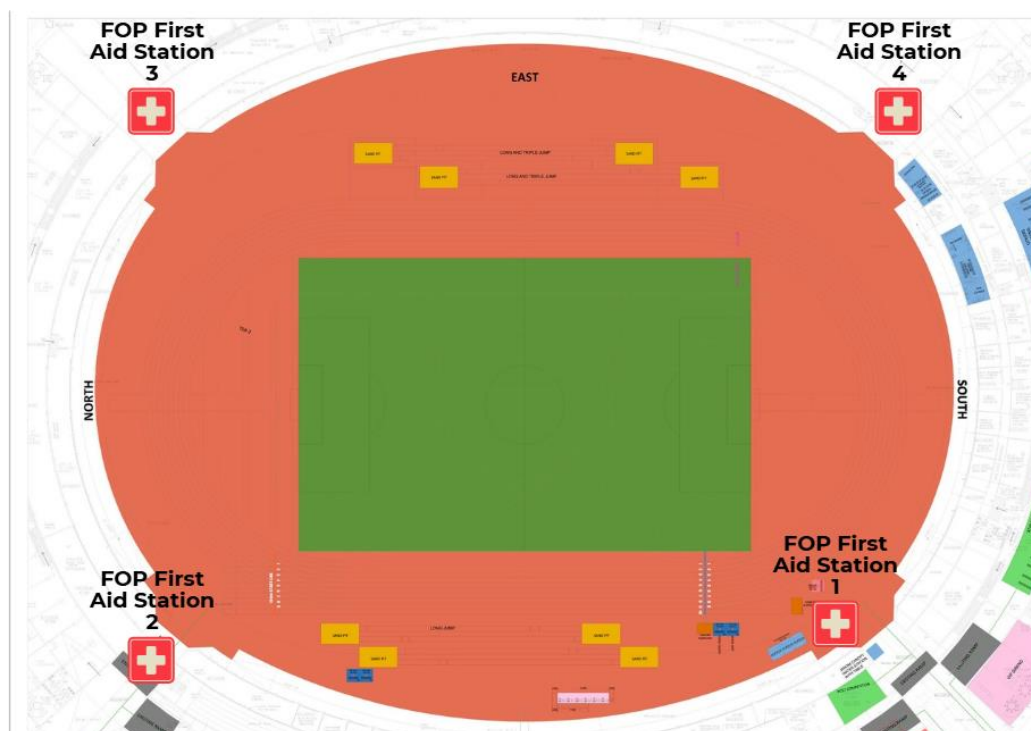

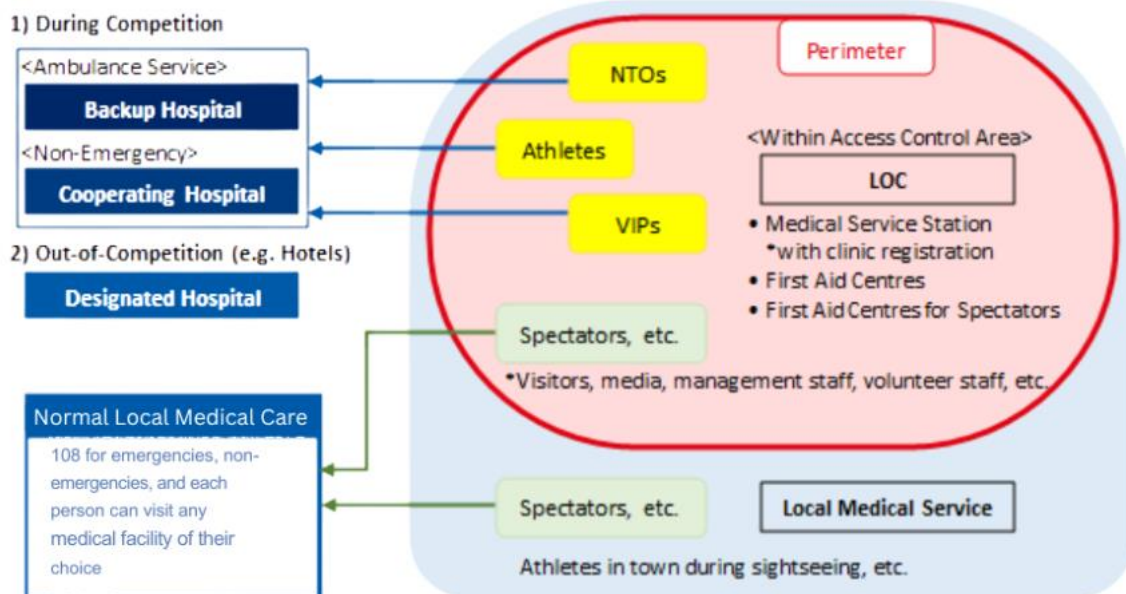

## 12.2 Training Venues

Each training venue will have a first aid station.

## 12.3 Warm-up Area

The warm-up area, located next to the competition venue, will have an on-site first aid service and a fully equipped first aid station.

If an athlete is injured, they will be transported to the Medical Centre in the stadium for treatment. In the case of a serious injury, ambulances and paramedics will be stationed near both the stadium and the warm-up area.

Athletes or officials can alert any medical staff for assistance, or call the Emergency Ambulance Service at **108** to go to the nearest available hospital.

## 12.4 Dedicated Hospitals

<b>1</b>	<b>Government</b>
○	All India Institute of Medical Sciences, Sri Aurobindo Marg, Ansari Nagar East, New Delhi-110029 <a href="https://maps.app.goo.gl/Nx7mdiMbANz1j5Vg7">https://maps.app.goo.gl/Nx7mdiMbANz1j5Vg7</a>
○	Safdarjung Hospital, Mahatma Gandhi Rd, Safdarjung Campus, Ansari Nagar West, New Delhi-110029 <a href="https://maps.app.goo.gl/SVYCCf2vFDaEZpPM6">https://maps.app.goo.gl/SVYCCf2vFDaEZpPM6</a>
<b>2</b>	<b>Private</b>
○	Center For Sports Injury (CSI), Safdarjung Enclave, New Delhi-110029 <a href="https://maps.app.goo.gl/BMid3wd8deaVMSCZ7">https://maps.app.goo.gl/BMid3wd8deaVMSCZ7</a>

## CAUTIONS

1. When going to the hospital, always be accompanied by your team doctor or other medical staff, along with an English-speaking staff member.
2. Be ready to explain any pre-existing medical conditions and medications so that the hospital can provide appropriate treatment.
3. Outside regular office hours, some medical institutions may request advance credit card details for payment. As not all hospitals accept credit cards, be prepared to pay in **Indian Rupees (₹)** if required.

## 12.5 Team Hotels

---

In case of medical need at the hotels, teams can contact the Medical SPOC(Single Point of Contact) or call the Information Desk at the hotel.

## CAUTIONS

1. If you are going to the hospitals, please contact the hospital in advance through your hotel to confirm whether it is possible to see a doctor.
2. When going to the hospital, please make sure you are accompanied by a team doctor or other medical staff along with an English-speaking staff.
3. Please understand that you will have to wait at the hospital, as you will not be given priority.
4. Please be prepared to explain about your pre-existing medical conditions and medications so that appropriate treatment can be provided at the hospital.
5. Outside of office hours, some medical institutions may ask you to submit your credit card information in advance for payment with credit cards. Some may not accept credit cards, so please be prepared to pay in Indian rupee (₹) as well.

## 12.6 Emergency Contact Numbers

---

For a medical emergency outside the opening hours of the Venue Medical Centres, please contact the Medical SPOC or the **Emergency Ambulance service on 108.**

## Emergency Contact Numbers

For a medical emergency outside the opening hours of the Medical Centre's venue, please contact the doctor on call (Telephone number to be confirmed) or the emergency ambulance service.

You can contact the LOC Medical Services team from 20th Sep – 6th Oct on the following numbers:

Brig. (Dr.) Bibhu Kalyan Nayak

Chief Medical Officer (CMO)

Mobile: +91 9627476903, E: bibhu443@gmail.com

Dr. Irfan

Mobile: +91 9310617975

### 12.7 Medical Delegate and Procedures during Competition

---

As mentioned in the introduction.

### 12.8 Medical Briefing

---

A meeting for all team physicians will be held on 26<sup>th</sup> September at 12:00 Hrs. This briefing will cover the locations of the Medical Centres as well as the medical pathways and procedures for the New Delhi 2025 Para Athletics World Championships. Further details will be available through the TIC and the Team Hotel Information Desks.

### 12.9 Medical Insurance

---

The LOC will provide **on-site medical care** for all accredited persons during the New Delhi 2025 Para Athletics World Championships. Any additional medical care costs must be covered by the patient or their National Paralympic Committee (NPC).

Each NPC is responsible for ensuring that all members of its delegation have personal, travel, and accident insurance for the Championships.

Except for ambulance transport, NPCs are also responsible for the cost of transportation to and from medical facilities. It is therefore recommended that purchased insurance covers these transportation expenses as well.

### 12.10 Narcotics and Psychotropics

---

It is strictly prohibited to import narcotics and psychotropics into India except in the case of prescription for a specific patient bringing them with permission before entering India.

You are allowed to bring Narcotics based Medications, but it must be declared on the letter head that those Medications will only be for personal use for your contingent during the 2025 New Delhi World Para Athletics Championships.

- Carry two lists of medications on your respective NPC letter head.
- Declare the same to the Customs in case you are asked for it. It might also be required to submit the additional copy to the Customs.

### 12.11 Distribution of Ice

---

Ice will be available for athletes at both the competition and training venues, provided by the LOC. **Containers for ice will not be supplied**, and teams are responsible for bringing their own.

### 12.12 Medication or Medical Equipment Import

---

**Medicine Import:** The team doctor accompanying each team must provide a list of all medicines being brought into India, including dosages and quantities.

It is also advised to carry a spare copy, which might be asked to submit at the customs/immigration in India.

### 12.13 Autonomic Dysreflexia and Boosting

---

The WPA Position Statement on autonomic dysreflexia and boosting applies to all participants at the New Delhi 2025 Para Athletics World Championships. This statement is referenced in the WPA Athletics Rules and Regulations (art. 3.2.4) and included in the WPA

Handbook (Section 2, Chapter 4.3), available at:

[www.paralympic.org/TheWPA/HWA/Handbook](http://www.paralympic.org/TheWPA/HWA/Handbook).

The World Para Athletics Medical Delegate will conduct and oversee assessments for autonomic dysreflexia and boosting. Assessments may take place at any appropriate time, including in Call Rooms or other warm-up areas before competition, as outlined in the WPA Position Statement. For further details, refer to the Operations Management document.

### 12.14 Infectious Disease Countermeasures

---

Infectious diseases, such as COVID-19, influenza, mumps, measles, or Norovirus, can spread directly or indirectly from an infected person to others. During sporting events, an outbreak can affect multiple team members, potentially preventing them from participating. The team environment increases the risk of transmission, as athletes share close contact, facilities, training equipment, accommodation, towels, water bottles, and other supplies.

**The primary focus must be prevention**, which includes:

- Practicing good hygiene at all times
- Applying Standard Infection Control Precautions strictly
- Ensuring full immunisation before arrival in New Delhi
- Taking measures to prevent secondary spread from infected individuals



**Secondary prevention** focuses on avoiding recurrence and stopping further spread from an identified source. Educating athletes on prevention is essential.

### **Good Personal Hygiene Guidance**

All teams must follow these measures:

- Wash hands with liquid soap and water after using the toilet and before using any equipment.
- Shower with soap and water after training and competition.
- Do not share towels or personal items.
- Wash towels, underwear, and sports clothing after every session.
- Keep cuts and sores covered with a clean, waterproof dressing.
- Wipe shared equipment surfaces before and after use with detergent wipes or spray and disposable paper towels.
- Shower before and after using swimming or spa pools.



## 13. Doping Control

The IPC is the responsible authority for the anti-doping program at the New Delhi 2025 Para Athletics World Championships and the IPC Anti-Doping Code applies to this event.

Samples (urine and/or blood) will be collected by trained and accredited Doping Control Officers (DCO) both in- and out-of-competition. Samples can be collected anytime, anywhere. At the time of notification, a trained and accredited chaperone, or a DCO will show the athlete their accreditation and advise which type of sample (blood, urine or both) the athlete will be asked to provide. The officer will then chaperone the athlete to the Doping Control Station (DCS) where the sample(s) will be collected. The athlete will be required to show official identification before providing a sample, so athletes should ensure that they always carry photo identification with them. Collected samples will be analyzed at the World Anti-Doping Agency (WADA) accredited Laboratory in New Delhi, India. Anti-Doping procedures will be overseen by the WPA Anti-Doping Delegate, David Herbert.

Ahead of the Championships athletes should make themselves aware of the relevant anti-doping rules and procedures, especially relating the registration of medication and the use of supplements. Athletes should also consider any modifications they may need to the doping control process and ensure they have the necessary equipment (such as new catheters etc., with them so that sample collection can proceed). Please refer to the AD section of the WPA website for more information [Athletics - Anti-Doping](#)

### 13.1 Doping Control Procedures

---

Athletes may have an illness or medical condition that requires a particular medication or procedure. If this medication or procedure contains a prohibited substance or involves the use of a prohibited method (one that appears on the [WADA Prohibited List](#)), the athlete may need to apply for a Therapeutic Use Exemption (TUE). A TUE gives the athlete an exemption to possess/use the substance or method, while competing in sport.

For the New Delhi 2025 World Para Athletics World Championships, the IPC manages the TUE application and recognition process for all participating athletes. All athletes must apply to the IPC for a TUE (or for recognition of an existing TUE) if they wish to use a prohibited substance or method in connection with the World Para Athletics World Championships.

### 13.2 Athletes that already have a valid TUE certificate of approval

---

If an athlete already has a TUE issued by their National Anti-Doping Organisation, the TUE will not be valid unless and until it is recognised by the IPC. The athlete, NADO or NPC can submit a request for recognition by email to [tue@paralympic.org](mailto:tue@paralympic.org) quoting the TUE reference number in ADAMS. Further information on recognition can be found on the [TUE section of the IPC website](#) under 'Recognising existing TUEs'.

### 13.3 Athletes that need to apply for a new TUE

---

All athletes must apply to the IPC by submitting the completed TUE application form with supporting medical documentation either via ADAMS, or by email to [tue@paralympic.org](mailto:tue@paralympic.org). Submissions must be in English. Further information on applying can be found on the TUE section of the IPC website under 'TUE application process'.

The TUE application form is available to download from the IPC website:

<https://www.paralympic.org/antidoping-tue>

### 13.4 Retroactive TUE

---

For any athlete, retroactive applications may also be considered if:

- Emergency or urgent treatment of a medical condition was necessary.
- There was insufficient time, opportunity or other exceptional circumstances that prevented the athlete from submitting a TUE application for the TUE prior to sample collection.
- As per the International Federation anti-doping rules, you were not permitted or required to apply for a prospective (in advance) TUE.  
If the athlete is a lower-level athlete who is not under the jurisdiction of an International Federation or NADO and were tested.
- The athlete used Out-of-Competition, for Therapeutic reasons, a Prohibited Substance that is only prohibited In-Competition (for example, glucocorticoids)

**Important note:**

**Using a prohibited substance or method without a TUE could result in an Anti-Doping Rule Violation.**

## 14. Cultural Experiences and Stalls

### 14.1 Ministry of Textiles – Handloom & Handicraft Stalls

---

The Ministry of Textiles will actively participate in showcasing India's rich textile and craft heritage. A total of 10 stalls will be established, comprising 5 handloom stalls and 5 handicraft stalls.

These stalls will feature diverse traditional weaves, fabrics, and artisan products from across the country, allowing international guests and participants to experience the depth of India's cultural artistry.

### 14.2 TRIFED – Araku Valley Café cum Stall (Tribal Art & Crafts)

---

The Tribal Cooperative Marketing Development Federation of India (TRIFED) will establish and operate an Araku Valley Café cum stall, which will serve as both a cultural and experiential hub. The café will highlight the unique coffee of the Araku Valley, along with a curated display of tribal art and handicrafts.

This initiative will showcase the rich heritage and creativity of India's tribal communities, providing visitors with both a cultural and culinary experience.

### 14.3 Para Sports Experience Zone – Ottobock and Ministry of Social Justice and Empowerment

---

In alignment with the inclusive spirit of the championship, a dedicated Para Sports Experience Zone will be created. The zone has been designed by Ottobock, a leading global company specializing in prosthetics, orthotics, and assistive technology in association with the Ministry of Social Justice and Empowerment.

Ottobock will also manage and operate the zone, offering visitors and participants a hands-on opportunity to understand para sports equipment and technology. This initiative will raise awareness, provide interactive learning, and strengthen the event's emphasis on accessibility and inclusivity.

## 14.4 Souvenir Shop

---

The Souvenir Shop will be a vibrant and engaging space set up during the IndianOil New Delhi 2025 World Para Athletics Championship, offering visitors a chance to take home meaningful keepsakes that represent both the championship and Indian culture. The shop will showcase a wide range of customized, cultural, and handcrafted items that blend sports spirit with traditional artistry.

The collection will include:

**Event-Branded Merchandise:** T-shirts, caps, mugs, keychains, badges, and other memorabilia featuring the WPA World Championship identity.

**Cultural Souvenirs:** Miniature handicrafts, ethnic jewellery, decorative items, and local artworks reflecting Indian heritage.

**Personalized Products:** Customized name-engraved accessories, photo souvenirs, and themed collectibles.

The Souvenir Shop will serve as both a memory corner for participants and visitors and a cultural showcase for international guests. It will allow them to carry back a piece of the event and India's tradition, ensuring that the championship experience remains with them long after they leave.

## 14.5 Mehndi Stall

---

Mehndi (henna) is an ancient art form, known for its intricate patterns and its cultural significance in India. The stall will provide an opportunity for both Indian and international guests to experience this traditional form of body art.

2wd tmjj5

Highlights of the Stall:

**Traditional Mehndi Designs:** Beautiful hand and palm patterns inspired by Indian and fusion styles.

**Cultural Experience:** Live demonstration of henna application and explanation of its significance in Indian festivals and ceremonies.

**Safe & Natural Henna:** Use of skin-friendly, organic mehndi cones to ensure safety and comfort for all visitors.

The Mehndi Stall will not only be a fun engagement spot but also a cultural bridge, allowing foreign participants to connect with Indian heritage in a personal and memorable way.

## 15. Appendices

### 15.1 Appendix 1

---

#### Competition schedule

<https://www.paralympic.org/athletics/new-delhi-2025>

## 15.2 Appendix 2

### Athlete Flow Diagram

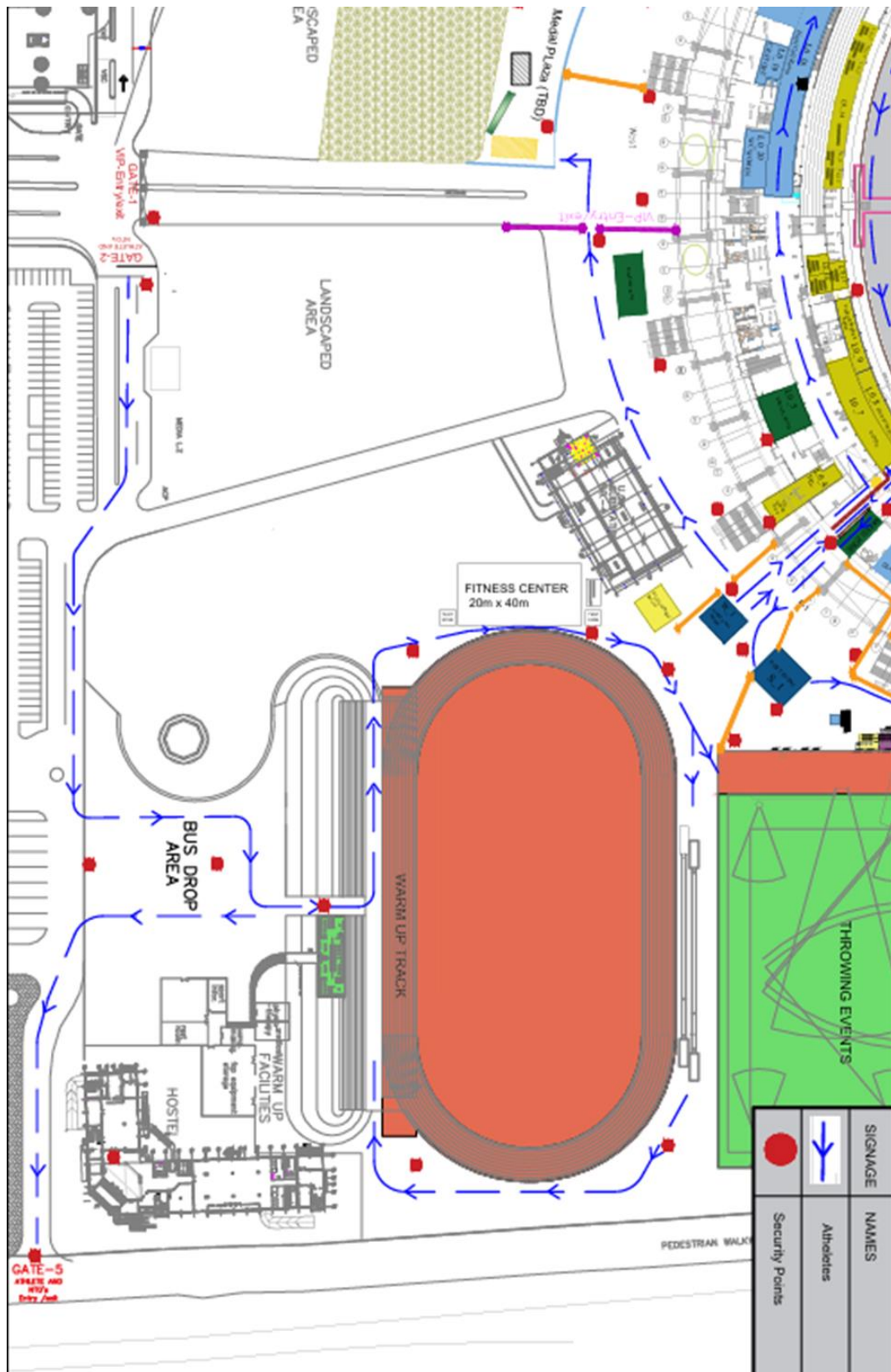



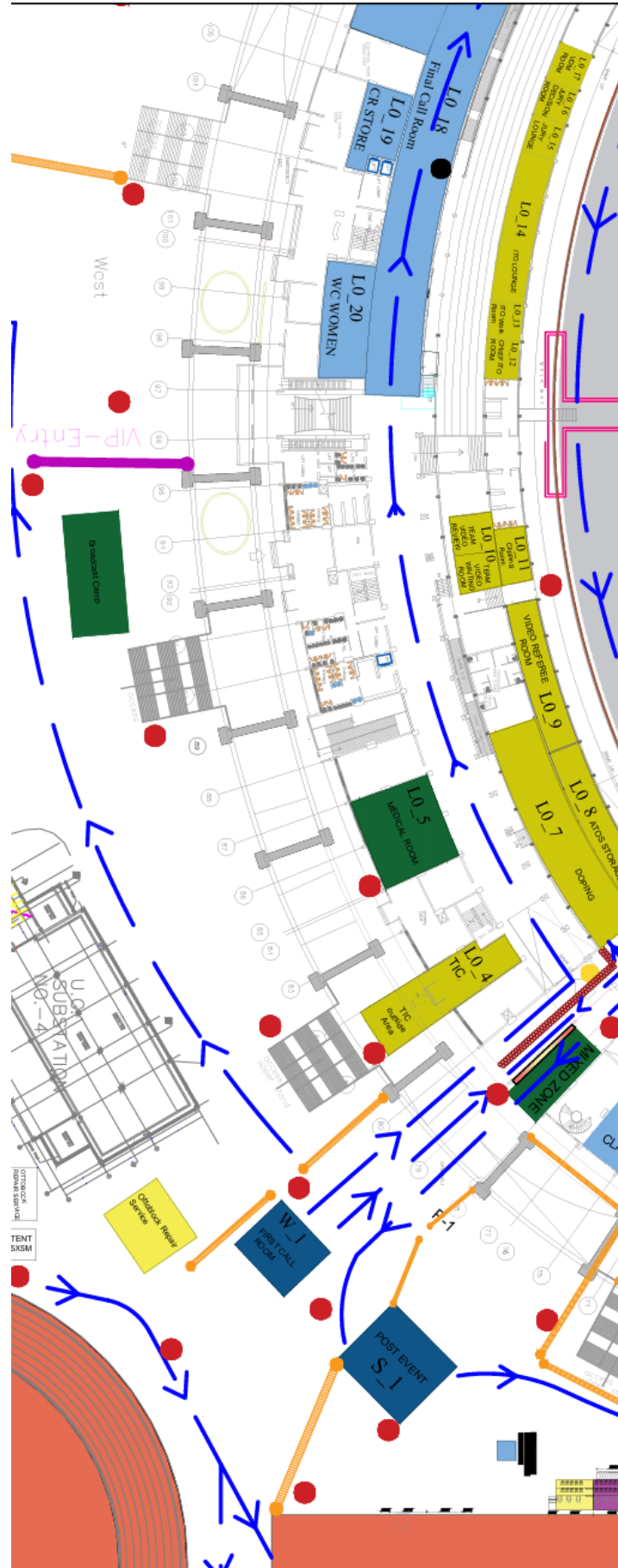



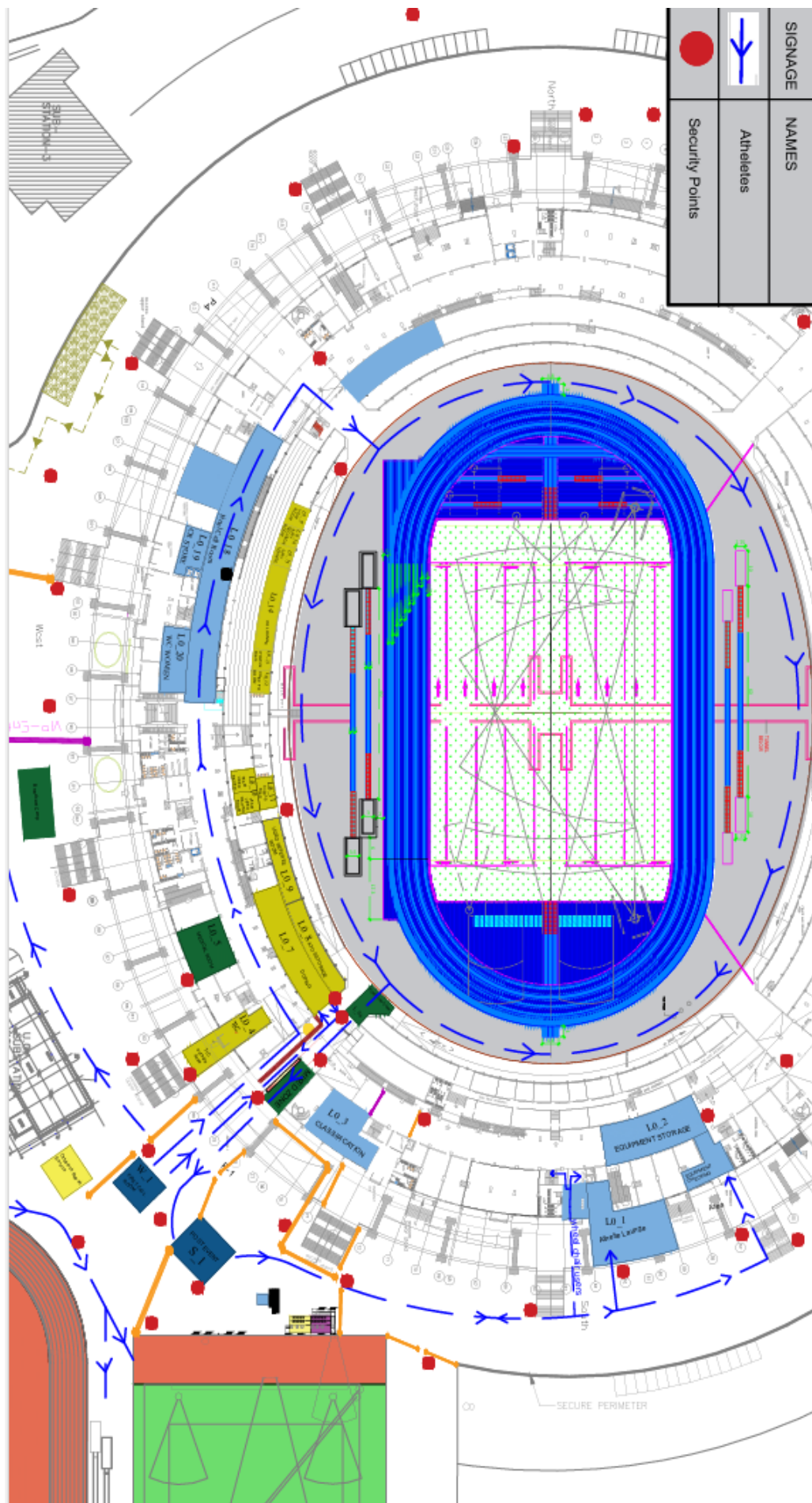

## 15.3 Appendix 3

### WPA Official Implements List

The document will be made available through official channels at a later stage

## 15.4 Appendix 4

### Medal Ceremonies Schedule

The medal ceremonies schedule is subject to change and any amendments to the one shown will be communicated accordingly.

Victory Session 1 - 27 September					
16:00 - 16:36					
Meeting Time	VC Start	Gender	Event Name	Eligible Classes	Round
15:30	16:00	Women's	Long Jump T37	T37	Final
15:30	16:06	Men's	5000m T11	T11	Final
15:30	16:12	Women's	Shot Put F41	F41	Final
15:40	16:18	Women's	Javelin Throw F46	F45, F46	Final
15:40	16:24	Women's	Shot Put F36	F36	Final
15:45	16:30	Men's	100m T71	T71	Final
15:45	16:36	Women's	100m T71	T71	Final

Victory Session 2 - 28 September					
11:30 - 12:00					
Meeting Time	VC Start	Gender	Event Name	Eligible Classes	Round
11:00	11:30	Men's	Long Jump T11	T11	Final
11:00	11:36	Women's	Discus Throw F53	F51, F52, F53	Final
11:00	11:42	Men's	Shot Put F37	F37	Final
11:15	11:48	Men's	High Jump T63	T42, T63	Final
11:15	11:54	Women's	400m T20	T20	Final
11:15	12:00	Men's	100m T47	T45, T46, T47	Final

Victory Session 3 - 28 September					
16:00 - 16:42					
Meeting Time	VC Start	Gender	Event Name	Eligible Classes	Round
15:30	16:00	Women's	Discus Throw F57	F56, F57	Final
15:30	16:06	Men's	Shot Put F55	F54, F55	Final
15:30	16:12	Women's	Javelin Throw F13	F12, F13	Final
15:40	16:18	Men's	Long Jump T20	T20	Final
15:40	16:24	Men's	Shot Put F12	F12	Final
15:45	16:30	Women's	1500m T11	T11	Final
15:45	16:36	Women's	1500m T13	T12, T13	Final
15:45	16:42	Women's	5000m T54	T53, T54	Final

Victory Session 4 - 29 September					
11:30 - 12:42					
Meeting Time	VC Start	Gender	Event Name	Eligible Classes	Round
11:00	11:30	Men's	Club Throw F32	F31, F32	Final
11:00	11:36	Men's	Javelin Throw F57	F55, F56, F57	Final
11:00	11:42	Men's	100m T12	T12	Final
11:15	11:48	Women's	100m T13	T13	Final
11:15	11:54	Men's	Long Jump T47	T45, T46, T47	Final
11:25	12:00	Men's	400m T72	T72	Final
11:25	12:06	Women's	400m T72	T72	Final
11:35	12:12	Women's	Shot Put F37	F37	Final
11:35	12:18	Men's	100m T37	T37	Final
11:45	12:24	Men's	100m T38	T38	Final
11:45	12:30	Men's	5000m T54	T53, T54	Final
11:55	12:36	Women's	400m T34	T34	Final
11:55	12:42	Women's	400m T37	T37	Final

Victory Session 5 - 29 September					
16:00 - 16:30					
Meeting Time	VC Start	Gender	Event Name	Eligible Classes	Round
15:30	16:00	Women's	Discus Throw F44	F43, F44	Final
15:30	16:06	Men's	Shot Put F53	F53	Final
15:30	16:12	Women's	Long Jump T12	T12	Final
15:40	16:18	Men's	400m T36	T36	Final
15:40	16:24	Men's	Shot Put F40	F40	Final
15:45	16:30	Women's	Discus Throw F64	F62, F64	Final

Victory Session 6 - 30 September					
11:30 - 12:36					
Meeting Time	VC Start	Gender	Event Name	Eligible Classes	Round
11:00	11:30	Women's	Javelin Throw F34	F33, F34	Final
11:00	11:36	Men's	Discus Throw F52	F51, F52	Final
11:00	11:42	Women's	100m T38	T38	Final
11:15	11:48	Women's	100m T47	T45, T46, T47	Final
11:15	11:54	Men's	400m T34	T33, T34	Final
11:25	12:00	Men's	Long Jump T63	T42, T61, T63	Final
11:25	12:06	Women's	Shot Put F20	F20	Final
11:35	12:12	Women's	800m T53	T51, T52, T53	Final
11:35	12:18	Men's	Javelin Throw F46	F45, F46	Final
11:45	12:24	Women's	800m T54	T54	Final
11:45	12:30	Men's	400m T53	T53	Final
11:55	12:36	Women's	400m T11	T11	Final

Victory Session 7 - 30 September					
16:00 - 16:48					
Meeting Time	VC Start	Gender	Event Name	Eligible Classes	Round
15:30	16:00	Men's	Discus Throw F56	F54, F55, F56	Final
15:30	16:06	Women's	Shot Put F54	F53, F54	Final

15:30	16:12	Men's	1500m T13	T12, T13	Final
15:40	16:18	Men's	200m T35	T35	Final
15:40	16:24	Men's	Long Jump T12	T12	Final
15:45	16:30	Men's	Shot Put F41	F41	Final
15:45	16:36	Men's	400m T54	T54	Final
15:55	16:42	Men's	400m T20	T20	Final
15:55	16:48	Men's	100m T44	T43, T44	Final

Victory Session 8 - 1 October					
11:30 - 12:54					
Meeting Time	VC Start	Gender	Event Name	Eligible Classes	Round
11:00	11:30	Women's	Club Throw F32	F31, F32	Final
11:00	11:36	Men's	Javelin Throw F44	F42, F43, F44	Final
11:00	11:42	Women's	Shot Put F34	F34	Final
11:15	11:48	Men's	200m T37	T37	Final
11:15	11:54	Women's	200m T13	T13	Final
11:25	12:00	Men's	Shot Put F11	F11	Final
11:25	12:06	Men's	100m T72	T72	Final
11:35	12:12	Women's	100m T72	T72	Final
11:40	12:18	Men's	100m T13	T13	Final
11:45	12:24	Women's	Long Jump T63	T42, T61, T63	Final
11:55	12:30	Men's	Javelin Throw F64	F61, F62, F63, F64	Final
11:55	12:36	Women's	100m T36	T36	Final
12:05	12:42	Men's	100m T64	T62, T64	Final
12:15	12:48	Men's	400m T11	T11	Final
12:15	12:54	Men's	1500m T11	T11	Final

Victory Session 9 - 1 October					
16:00 - 16:36					
Meeting Time	VC Start	Gender	Event Name	Eligible Classes	Round
15:30	16:00	Women's	Javelin Throw F56	F55, F56	Final
15:30	16:00	Men's	Shot Put F36	F36	Final
15:30	16:06	Women's	Javelin Throw F54	F52, F53, F54	Final

15:30	16:12	Women's	1500m T54	T53, T54	Final
15:40	16:18	Men's	Long Jump T13	T13	Final
15:40	16:24	Women's	Discus Throw F11	F11	Final
15:45	16:30	Women's	100m T37	T37	Final

Victory Session 10 - 2 October					
11:30 - 12:42					
Meeting Time	VC Start	Gender	Event Name	Eligible Classes	Round
11:00	11:30	Men's	Shot Put F32	F32	Final
11:00	11:36	Men's	100m T34	T33, T34	Final
11:00	11:42	Women's	100m T34	T33, T34	Final
11:15	11:48	Women's	Long Jump T38	T36, T38	Final
11:15	11:54	Women's	100m T44	T43, T44	Final
11:25	12:00	Women's	400m T12	T12	Final
11:25	12:06	Men's	Shot Put F20	F20	Final
11:35	12:12	Men's	Javelin Throw F38	F38	Final
11:35	12:18	Men's	400m T52	T51, T52	Final
11:45	12:24	Men's	400m T38	T35, T38	Final
11:50	12:30	Women's	100m T63	T42, T63	Final
11:55	12:36	Women's	100m T11	T11	Final
12:00	12:42	Women's	100m T64	T62, T64	Final
12:10	12:48	Men's	5000m T13	T12, T13	Final
12:15	12:54	Men's	800m T20	T20	Final

Victory Session 11 - 2 October					
16:00 - 16:42					
Meeting Time	VC Start	Gender	Event Name	Eligible Classes	Round
15:30	16:00	Men's	Javelin Throw F34	F33, F34	Final
15:30	16:06	Women's	Shot Put F57	F55, F56, F57	Final
15:30	16:12	Men's	1500m T54	T53, T54	Final
15:40	16:18	Men's	Long Jump T38	T35, T38	Final
15:40	16:24	Men's	Discus Throw F37	F37	Final
15:45	16:30	Women's	Shot Put F46	F45, F46	Final

15:45	16:36	Men's	400m T37	T37	Final
15:45	16:42	Women's	400m T47	T45, T46, T47	Final

Victory Session 12 - 3 October					
11:30 - 12:42					
Meeting Time	VC Start	Gender	Event Name	Eligible Classes	Round
11:00	11:30	Men's	Club Throw F51	F51	Final
11:00	11:36	Men's	Long Jump T44	T43, T44	Final
11:00	11:42	Women's	Shot Put F32	F32	Final
11:15	11:48	Men's	Discus Throw F57	F57	Final
11:15	11:54	Men's	400m T47	T45, T46, T47	Final
11:25	12:00	Men's	Shot Put F46	F45, F46	Final
11:25	12:06	Women's	100m T53	T51, T52, T53	Final
11:35	12:12	Men's	100m T53	T53	Final
11:35	12:18	Men's	Long Jump T64	T62, T64	Final
11:45	12:24	Women's	100m T54	T54	Final
11:45	12:30	Women's	200m T38	T38	Final
11:55	12:36	Women's	1500m T20	T20	Final

Victory Session 13 - 3 October					
16:00 - 16:30					
Meeting Time	VC Start	Gender	Event Name	Eligible Classes	Round
15:30	16:00	Women's	Shot Put F64	F61, F62, F63, F64	Final
15:30	16:06	Women's	Discus Throw F41	F40, F41	Final
15:40	16:12	Men's	Long Jump T37	T37	Final
15:40	16:18	Men's	Discus Throw F11	F11	Final
15:45	16:24	Women's	Shot Put F44	F42, F43, F44	Final
15:45	16:30	Men's	100m T36	T36	Final



Victory Session 14 - 4 October					
11:30 - 13:00					
Meeting Time	VC Start	Gender	Event Name	Eligible Classes	Round
11:00	11:30	Men's	Discus Throw F44	F43, F44	Final
11:00	11:36	Women's	Shot Put F33	F33	Final
11:10	11:42	Men's	400m T12	T12	Final
11:15	11:48	Men's	High Jump T47	T45, T46, T47	Final
11:20	11:54	Men's	400m T13	T13	Final
11:25	12:00	Women's	Long Jump T64	T43, T44, T62, T64	Final
11:25	12:06	Men's	800m T53	T51, T52, T53	Final
11:35	12:12	Men's	100m T54	T54	Final
11:40	12:18	Men's	Shot Put F35	F35	Final
11:45	12:24	Women's	200m T36	T36	Final
11:50	12:30	Women's	200m T35	T35	Final
11:55	12:36	Men's	Discus Throw F64	F62, F64	Final
12:00	12:42	Women's	400m T53	T51, T52, T53	Final
12:10	12:48	Women's	400m T54	T54	Final
12:15	12:54	Women's	100m T12	T12	Final
12:20	13:00	Men's	100m T11	T11	Final

Victory Session 15 - 4 October					
16:00 - 16:24					
Meeting Time	VC Start	Gender	Event Name	Eligible Classes	Round
15:30	16:00	Women's	Shot Put F12	F11, F12	Final
15:30	16:06	Women's	Long Jump T47	T45, T46, T47	Final
15:35	16:12	Men's	Javelin Throw F54	F52, F53, F54	Final
15:40	16:18	Men's	1500m T20	T20	Final
15:40	16:24	Women's	Shot Put F35	F35	Final

Victory Session 16- 5 October					
11:30 - 12:36					
Meeting Time	VC Start	Gender	Event Name	Eligible Classes	Round
11:00	11:30	Women's	Club Throw F51	F51	Final
11:00	11:36	Men's	Shot Put F38	F38	Final
11:00	11:42	Women's	Long Jump T11	T11	Final
11:15	11:48	Men's	Shot Put F57	F56, F57	Final
11:15	11:54	Men's	High Jump T64	T44, T64	Final
11:25	12:00	Men's	100m T52	T52	Final
11:25	12:06	Men's	100m T35	T35	Final
11:35	12:12	Men's	100m T51	T51	Final
11:35	12:18	Men's	Javelin Throw F13	F12, F13	Final
11:45	12:24	Women's	800m T34	T33, T34	Final
11:45	12:30	Men's	1500m T46	T45, T46	Final
11:55	12:36	Mixed	Universal 4x100m Relay	T10,30,40,50,60	Final

Victory Session 17 - 5 October					
16:00 - 16:30					
Meeting Time	VC Start	Gender	Event Name	Eligible Classes	Round
15:30	16:00	Women's	Discus Throw F55	F54, F55	Final
15:30	16:06	Women's	Long Jump T20	T20	Final
15:35	16:12	Men's	Shot Put F33	F33	Final
15:40	16:18	Men's	1500m T52	T51, T52	Final
15:45	16:24	Men's	800m T34	T33, T34	Final
15:50	16:30	Women's	Shot Put F40	F40	Final

Victory Session 18- 5 October							
18:10 - 20:36							
Start time	Finish time	Meeting Time	VC Start	Gender	Event Name	Eligible Classes	Round
17:15	17:23	17:45	18:10	Women's	200m T12	T12	Final
17:23	17:31	17:50	18:16	Women's	200m T11	T11	Final
17:31	17:38	17:55	18:23	Men's	200m T51	T51	Final
17:42	17:49	18:00	18:37	Women's	100m T35	T35	Final
17:49	17:56	18:10	18:44	Men's	100m T63	T42, T63	Final
17:10	18:00	18:20	18:50	Women's	Discus Throw F38	F37, F38	Final

18:00	18:07	18:25	18:56	Women's	200m T37	T37	Final
18:07	18:14	18:30	19:02	Women's	200m T47	T45, T46, T47	Final
18:14	18:21	18:35	19:08	Men's	200m T44	T44	Final
18:23	18:30	18:45	19:14	Women's	200m T44	T44	Final
18:35	18:43	19:00	19:30	Men's	1500m T38	T37, T38	Final
17:37	18:45	19:00	19:36	Men's	Long Jump T36	T36	Final
18:45	18:52	19:10	19:42	Women's	400m T13	T13	Final
18:52	18:59	19:15	19:54	Men's	400m T62	T43, T62	Final
17:55	19:05	19:30	20:00	Men's	Shot Put F63	F42, F61, F63	Final
18:59	19:06	19:30	20:06	Women's	400m T38	T36, T38	Final
19:10	19:18	19:40	20:12	Men's	800m T54	T54	Final
18:18	19:25	19:45	20:18	Men's	Javelin Throw F41	F40, F41	Final
17:00	19:30	19:45	20:24	Men's	Shot Put F34	F34	Final
19:23	19:30	20:00	20:30	Men's	200m T64	T64	Final
19:30	19:37	20:00	20:36	Women's	200m T64	T64	Final